

# PRODUCTS PORTFOLIO

[www.alosooluae.com](http://www.alosooluae.com)







## Table of Content

### PRODUCTS RANGE

SN. No.	PG. No.
<b>01 . Hollow Metal Door</b>	
1.1 Steel Door Construction Overview	04-05
1.2 Steel Frame Construction	06
1.3 Door Infill Details, Vision Panel & Fire Rated Louver Details	07
1.4 Fire Rated Single Leaf Doorset With / Without Vision Panel	08-09
1.5 Fire Rated Double Leaf Doorset With / Without Vision Panel	10-11
<b>02 . Metal Access Panel</b>	
2.1 Fire Rated Access Panel	12-13
<b>03 . Metal Louver Door</b>	
3.1 Fully Louvered Doors (Substation Doors) Sand Trap	14-15
<b>04 . Wooden Door</b>	
4.1 Fire Rated Wooden Doors	16-17
<b>05 . Metal Glazed Doors &amp; Partition</b>	
5.1 Fully Glazed Swing Latched Single and Double Leafs Steel Door Sets (E & EW)	18-19
5.2 Fully Glazed Swing Latched Single And Double Leafs Steel Door Sets- Integrity and Insulation	20-21
5.3 Fully Glazed Doorset With Side Light And Transom Panels (E & EW)	22-23
5.4 Glazed Steel Windows Fixed And Openable (E, EW, EI)	24-25
5.5 Fully Glazed Steel Partition - Unlimited Width	26-27
5.6 Fully Glazed Butt Joint System- Integrity and Insulation	28-29
5.7 Steel Fire Rated Glazed Curtain Jansen Walls Systems Steel - (EW)	30-31
<b>06 . Aluminum Glazed Doors &amp; Partition</b>	
6.1 Fire Rated Aluminium Glazed Doors and Partitions	32-33
<b>07 . Ballistic and Security System Product</b>	
7.1 Bullet Proof Doors & Windows	34-35
7.2 Security And Detention Doors & Windows	36-37
<b>08 . Metal Products</b>	
8.1 Garbage And Linen Chute Doors (Fire Rated)	38-39
8.2 Sectional Overhead Doors	40
8.3 Rolling Shutters	41
8.4 Manufacturer Of Fire Cabinets	42-43
8.5 Steel And Stainless Steel Hand Rails	44
8.6 Steel and Stainless steel Bollard Bar	45
<b>09 . Selection Guide</b>	
9.1 Fire Door Selection Guide	46-47
9.2 Door Handling	48
9.3 Powder Coating, Wooden Finish & Enamel Paint	49
9.4 Architectural Hardware Fire Rated Hardware -Listed And Certified	50-51
9.5 Factory Location & Address	52

#### Abu Dhabi Civil Defence



#### Abu Dhabi Civil Defence Installation



#### Sharjah Civil Defence



#### Dubai Civil Defence



#### Umm Al Quwain Civil Defence



#### Ajman Civil Defence



UAE  
CIVIL DEFENCE  
APPROVED

KSA  
CIVIL DEFENCE  
APPROVED

KUWAIT  
CIVIL DEFENCE  
APPROVED

JORDAN  
CIVIL DEFENCE  
APPROVED

OMAN  
CIVIL DEFENCE  
APPROVED

BAHRAIN  
CIVIL DEFENCE  
APPROVED





## Description

Steel Doors are fabricated fully Flush seamless, with seam Glazed Panel, Stiffeners and laminated core models suitable for any commercial residential buildings, industrial, hospitals, hotels, schools, available with wide range of glass lights and with louver preparation ETC.

Different types of cores with single and double leaf configuration.

Customized Design as per Customer requirements.

## Specifications

<b>Construction</b>	Mechanically interlocked, hemmed vertical edge seam with inverted top and bottom channel welded to both face sheets
<b>Materials</b>	Cold rolled galvanized steel sheet confirm to ASTM or equivalent standard
<b>Gauge/Door Thickness</b>	45-80mm thick door with skin thickness 0.9 to 2mm
<b>Core Or Insulation</b>	Honeycomb / Rockwool
<b>Application</b>	Light to extra heavy duty use as per SDI
<b>Frame Gauge/Jamb Depth</b>	1.5 to 4mm/ up to 500mm
<b>Ironmongery</b>	Certified as per door test standard BS, EN and UL
<b>Fire Rating</b>	Up to 240 minutes as per EN/BS and 120 minutes as per UL
<b>Test Standard</b>	EN 1634-1/ BS 476 part20-22/ UL10C
<b>Certification</b>	Intertek, BM trada, Exova Warrington
<b>Finish</b>	Powder coated/ Wood finish/ Wet paint meets ANSI A 250.3 and ANSI A 250.10

## Additional Features

- Seamless welded design
- Vision panel
- Bottom Louver/ Grille
- Alternate Stainless-steel material
- Additional top panel
- Knock down frame /Groove frame with kerf gasket
- Smoke rated as per UL1784 / BS476 section 31.1/BSEN 1634-3
- STC/Acoustic and Fire rating together up to 47 db





**Welded Type**



**Knock down Steel Frame**

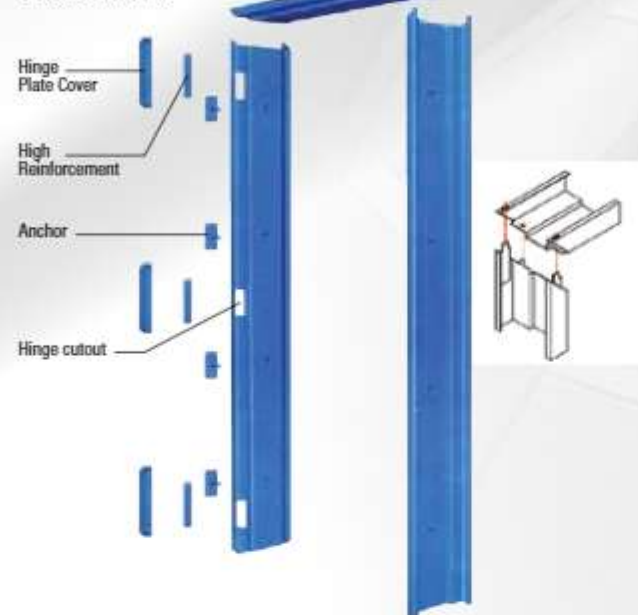

**MW Series Frames Construction Features**

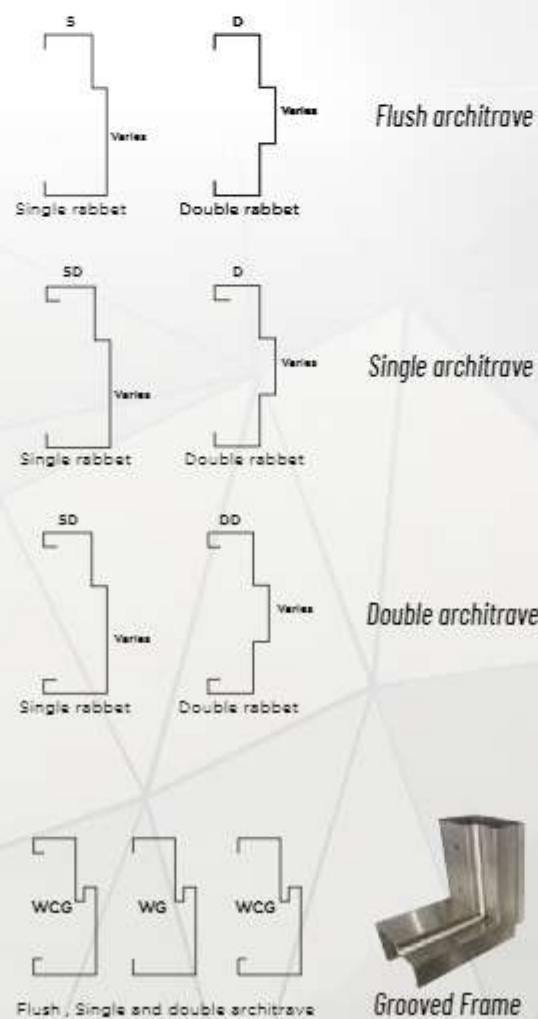
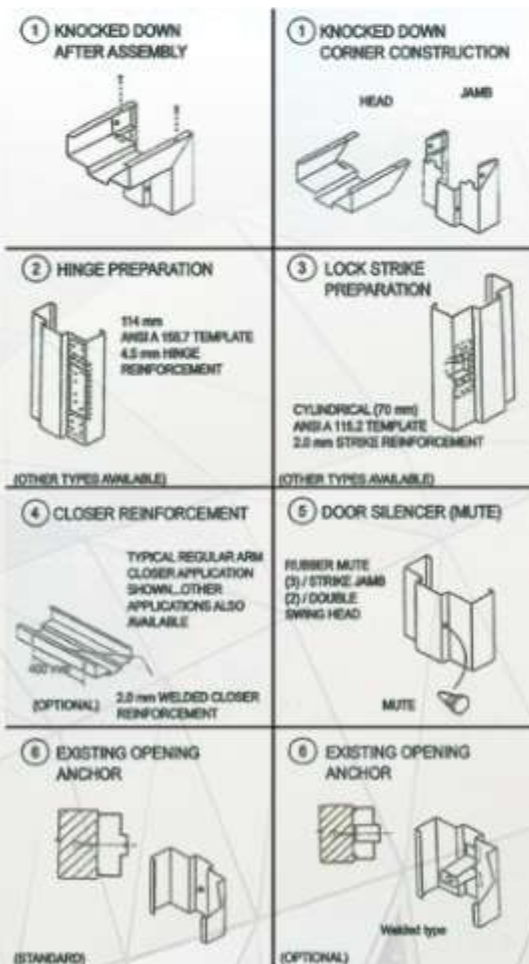

**Rock Wool / Mineral Core**

Rock Wool / Mineral Core made from molten basalt rocks spun to fine fibers & bonded with thermosetting phenol resin used for thermal insulation, acoustical & fire barrier.

Provide with suitable vertical stiffeners.

Commonly used for our fire rated doors.



**Honeycomb Core**

Honeycomb Core is made from layers of paper or cardboard together by parallel & uniformly spaced lines of adhesive, light weight & high strength.

Glued to the interior surface of the door skin door leaf is the pressed for a couple of hours to maintain the flatness of the door.

Compressive strength is equal to 1.4 kg/cm<sup>2</sup>, Commonly used for fire rated doors.

**Vision Panel**

Door leaf can be provided with vision Panel for visibility.



**Louvers - Fire Rated**

Labeled doors can be provided with optional louvers with fusible link / intumescent for a maximum size of 600 x 600 mm upto 90 minutes. Fire rated doors.





## Description

Steel doors are of flush or glazed panel with steel stiffeners and laminated core design suitable for any commercial residential buildings, industrial, hospitals, hotels, schools, available with wide range of glass lights and with louver preparation ETC.

Different types of cores with single and double leaf configuration.

*Our doors and frames can be customized to the customer needs in terms of design and build.*

## Specifications

<b>Construction</b>	Mechanically interlocked, hemmed vertical edge seam with inverted top and bottom channel welded to both face sheets
<b>Materials</b>	Cold rolled galvanized steel sheet confirm to ASTM or equivalent standard
<b>Gauge/Door Thickness</b>	45-80mm thick door with skin thickness 0.9 to 2mm
<b>Core Or Insulation</b>	Honeycomb / Rockwool
<b>Application</b>	Light to extra heavy duty use as per SDI
<b>Frame Gauge/Jamb Depth</b>	1.5 to 4mm/ up to 500mm
<b>Ironmongery</b>	Certified as per door test standard BS, EN and UL
<b>Fire Rating</b>	Up to 240 minutes as per EN/BS and 120 minutes as per UL
<b>Test Standard</b>	EN 1634-1/ BS 476 part20-22/ UL10C
<b>Certification</b>	Intertek, BM trada, Exova Warrington
<b>Finish</b>	Powder coated/ Wood finish/ Wet paint meets ANSI A 250.3 and ANSI A 250.10

## Additional Features

- Seamless welded design
- Vision panel
- Bottom Louver/ Grille
- Alternate Stainless-steel material
- Overhead Panel
- Knock down frame /Groove frame with kerf gasket
- Smoke rated as per UL1784 / BS476 section 31.1/BSEN 1634-3
- STC/Acoustic and Fire rating together up to 47db





## Description

Steel doors are of flush or glazed panel with steel stiffeners and laminated core design suitable for any commercial residential buildings, industrial, hospitals, hotels, schools, available with wide range of glass lights and with louver preparation ETC.

Different types of cores with single and double leaf configuration.

*Our doors and frames can be customized to the customer needs in terms of design and build.*

## Specifications

<b>Construction</b>	Mechanically interlocked, hemmed vertical edge seam with inverted top and bottom channel welded to both face sheets
<b>Materials</b>	Cold rolled galvanized steel sheet confirm to ASTM or equivalent standard
<b>Gauge/Door Thickness</b>	45-80mm thick door with skin thickness 0.9 to 2mm
<b>Core Or Insulation</b>	Honeycomb / Rockwool
<b>Application</b>	Light to extra heavy duty use as per SDI
<b>Frame Gauge/Jamb Depth</b>	1.5 to 4mm/ up to 500mm
<b>Ironmongery</b>	Certified as per door test standard BS, EN and UL
<b>Fire Rating</b>	Up to 240 minutes as per EN/BS and 120 minutes as per UL
<b>Test Standard</b>	EN 1634-1/ BS 476 part20-22/ UL10C
<b>Certification</b>	Intertek, BM trada, Exova Warrington
<b>Finish</b>	Powder coated/ Wood finish/ Wet paint meets ANSI A 250.3 and ANSI A 250.10

## Additional Features

- Seamless welded design
- Vision panel
- Bottom Louver/ Grille
- Alternate Stainless-steel material
- Additional top panel
- Knock down frame /Groove frame with kerf gasket
- Smoke rated as per UL1784 / BS476 section 31.1/BSEN 1634-3
- STC/Acoustic and Fire rating together up to 46 db





## Description

Fire Rated access doors for installation in fire resistance rated walls that is used to provide access to shafts chases and others concealed spaces.

## Specifications

<b>Construction</b>	Mechanically interlocked, hemmed vertical edge seam with inverted top and bottom channel welded to both face sheets and other special designs to suit with site requirements
<b>Materials</b>	Cold rolled galvanized steel sheet confirm to ASTM or equivalent standard
<b>Door Thickness/Gauge</b>	15 to 35 mm thick door with skin thickness 1.5, 1.2mm
<b>Core Or Insulation</b>	Honey Comb
<b>Application</b>	Vertical- Wall
<b>Frame Gauge</b>	1.5 ,1.2mm
<b>Ironmongery</b>	Tested and Certified as per BS 476 PART22-20 standard
<b>Fire Rating</b>	Up to 180 minutes
<b>Test Standard</b>	BS 476 part20-22
<b>Certification</b>	BM trada, Exova Warrington
<b>Finish</b>	Powder coated/ Wood finish/ Tiles/Gypsum

## Additional Features

- Seamless Flush design
- Door thickness can be up to 45mm
- Alternate Stainless-steel material
- Easily removable with special design pin hinges
- Different types of concealed locks and hinges
- Gypsum or tiles cladding to match with the wall finish



Concealed hinge



3 Point Lock



Cylinder



Budget Lock



Access Panel with Gypsum cladding





## Fully Louvered Doors (Substation Sand Trap Doors)

### Description

Steel doors can be provided with a variety of louvers designs and sizes. Louver permits free air passage controlling the volume by their size and design. They diffuse or control direction of air flow by different blade designs.

Louver doors are covered with different models' types blades & finishes. Specially designed to serve a certain need and requirement within the air movement and control.

It can be a part of doors as fully louvered or partially depends on the air flow required for doors or windows.

Manufactured with 1.2mm thick standard blade or the below specified different type of blades with special hardware like drop bolt, Tower bolt, pad bolt in addition to the standard hardware

- Standard C type
- Zee type
- V type
- Inverted Y type





## Description

Wooden doors are made for both interior and exterior application. Our Fire rated wooden doors are manufactured by a special core material. They are aesthetically designed to offer an architectural appeal to meet the clients requirements.

## Specifications

<b>Construction</b>	Fire rated core with hard wood lipping on the edges to meet FD60 and FD 90 criteria / Alternate Mineral core with stile and Rails
<b>Materials</b>	Fire rated core, mineral core and hard wood with density higher than 650kg/m <sup>3</sup>
<b>Gauge/Door Thickness</b>	54mm for FD60 minutes and 64mm for FD 90 minutes 45mm thick as per UL
<b>Facing</b>	Veneer, PVC, Plastic based laminates
<b>Application</b>	Light to extra heavy duty use as per SDI
<b>Frame</b>	Hard Wood material with density more than 650 kg/m <sup>3</sup> Alternate steel Frame
<b>Ironmongery</b>	Certified as per door test standard BS, EN, UL
<b>Glazing</b>	FD 90 minutes with glazing
<b>Fire Rating</b>	FD60 and FD90 minutes with glazing
<b>Test Standard</b>	BS 476 part22-20 - UL10C
<b>Certification</b>	BM trada, Intertek

Fire Rated Single Door





## Fully Glazed Swing Latched Single and Double Leafs Steel Door Sets (E & EW)

### Description

Alternative to steel doors, special designed fully glazed fire rated and non-fire rated glazed doors for traditional store front and entrance system, Narrow stiles and rails with special concealed hardware for good aesthetic view, increased glazed area slimmer profile integrity and intergrity with radiation control.

### Specifications

<b>Construction</b>	<b>Mechanically interlocked, hemmed vertical edge seam with inverted top and bottom channel welded to both face sheets /Alternate special designed mechanically formed narrow profiles</b>
<b>Materials</b>	Cold rolled galvanized steel sheet confirm to ASTM or equivalent standard
<b>Gauge/Door Thickness</b>	<b>52 to 60mm thick door with skin thickness 1.2 to 2.0 mm</b>
<b>Core Or Insulation</b>	Fully glazed- No core
<b>Glass</b>	<b>Fire rated glass 5 to 20mm thick / certified to E and EW</b>
<b>Application</b>	Light to extra heavy duty use as per SDI
<b>Frame Gauge/Jamb Depth</b>	<b>1.5 to 4mm/ up to 500mm</b>
<b>Ironmongery</b>	Tested and Certified as per door test standard BS and EN
<b>Fire Rating</b>	<b>Up to 176 minutes as per EN/BS</b>
<b>Test Standard</b>	EN 1634-1/ BS 476 part20-22
<b>Certification</b>	<b>Intertek, BM trada, Exova Warrington</b>
<b>Finish</b>	Powder coated/ Wood finish/ Wet paint meets ANSI A 250.3 and ANSI A 250.10

### Additional Features

- Seamless welded design
- Alternate Stainless-steel material
- Alternate glass specification
- Additional top panel
- Knock down frame /Groove frame with kerf gasket
- Smoke rated as per UL1784 / BS476 section 31.1/BS EN 1634-3
- Acoustical



Stainless Steel (Oval Shape)



Steel Powder Coating



Stainless Steel Mirror or Brush





## Fully Glazed Swing Latched Single And Double Leafs Steel Door Sets- Integrity and Insulation

### Specifications

<b>Construction</b>	<b>Mechanically formed special narrow profile insulated</b>
<b>Materials</b>	Cold rolled galvanized steel sheet confirm to ASTM or equivalent standard
<b>Gauge/Door Thickness</b>	<b>81 mm thick door with skin thickness 1.2 to 2.0 mm</b>
<b>Core Or Insulation</b>	Fully glazed- Special fire resistive infill
<b>Glass</b>	<b>Fire rated glass – fully insulated confirms to EI requirement</b>
<b>Application</b>	Light to extra heavy duty use as per SDI
<b>Frame Profiles</b>	<b>Mechanically formed special narrow profile - insulated</b>
<b>Ironmongery</b>	Tested and Certified as per door test standard BS and EN
<b>Fire Rating</b>	<b>EI 90 minutes single and EI 60, EW 120 for double door configuration</b>
<b>Test Standard</b>	EN 1634-1/ BS 476 part20-22
<b>Certification</b>	<b>Intertek, BM trada, Exova Warrington</b>
<b>Finish</b>	Powder coated/ Wood finish/ Wet paint meets ANSI A 250.3 and ANSI A 250.10

### Additional Features

- Alternate Stainless-steel material
- Alternate glass specification
- Additional top panel
- Smoke rated as per UL1784 / BS476 section 31.1/BSEN 1634-3
- Acoustical





## Fully Glazed Doorset With Side Light And Transom Panels (E & EW)

### Description

Alternative to steel doors, special designed fully glazed fire rated and non-fire rated glazed doors with side and top panels for traditional store front and entrance system, Narrow stiles and rails with standard and concealed hardware for good aesthetic view, increased glazed area with slimmer profile

### Specifications

<b>Construction</b>	<b>Mechanically formed special narrow profile</b>
<b>Materials</b>	Cold rolled galvanized steel sheet confirm to ASTM or equivalent standard
<b>Gauge/Door Thickness</b>	<b>60 mm thick door with skin thickness 1.2 to 1.8 mm</b>
<b>Size</b>	3000x 3000mm (wxh) and no limitation in width
<b>Core Or Insulation</b>	<b>Fully glazed- No core</b>
<b>Glass</b>	Fire rated glass
<b>Application</b>	<b>Light to extra heavy duty use as per SDI</b>
<b>Frame Profiles</b>	Mechanically formed special narrow profile
<b>Ironmongery</b>	<b>Tested and Certified as per door test standard BS and EN</b>
<b>Fire Rating</b>	E 180 minutes - EW 120 Minutes
<b>Test Standard</b>	<b>EN 1634-1/ BS 476 part20-22</b>
<b>Certification</b>	Intertek, BM trada, Exova Warrington
<b>Finish</b>	<b>Powder coated/ Wood finish/ Wet paint meets ANSI A 250.3 and ANSI A 250.10</b>

### Additional Features

- Alternate Stainless-steel material
- No limitation in width, height can be replicate by a separator
- Side lite and transom lite is separated with mullion and transom
- Alternate glass specification
- Smoke rated as per UL1784 / BS476 section 31.1/BSEN 1634-3
- Acoustical





## Description

Special designed fully glazed fire rated and non-fire rated fixed and openable glazed windows system. Narrow stiles and rails with concealed hardware for good aesthetic view, increased glazed area, slimmer profile integrity and insulation application special fire resistive infill for EI systems.

## Specifications

<b>Construction</b>	<b>Mechanically formed special narrow profile insulated</b>
<b>Materials</b>	Cold rolled galvanized steel sheet confirm to ASTM or equivalent standard
<b>Gauge/Door Thickness</b>	<b>50 mm thick door with skin thickness 1.2 to 1.8 mm / standard custom made profiles for insulated</b>
<b>Core Or Insulation</b>	Fully glazed- No infill for Intergrity (E) and EW, special fire resistive infill for Insulated EI
<b>Glass</b>	<b>Fire protection/ Fire resistive glass in single and Double Glazed unit(DGU)</b>
<b>Application</b>	Light to extra heavy duty use as per SDI
<b>Frame Profiles</b>	<b>Special mechanically formed narrow profile</b>
<b>Ironmongery</b>	Tested and Certified as per door test standard BS and EN for operable windows
<b>Fire Rating</b>	<b>E I 90 minutes as per EN/BS – E -135 minutes</b>
<b>Test Standard</b>	EN 1364-1/ BS 476 part20-22
<b>Certification</b>	<b>Intertek, Exova Warrington</b>
<b>Finish</b>	Powder coated/ Wood finish/ Wet paint meets ANSI A 250.3 and ANSI A 250.10

## Additional Features

- Seamless welded design
- Alternate Stainless-steel material
- Alternate glass specification
- Smoke rated as per UL1784 / BS476 section 31.1/BSEN 1634-3
- Acoustical





## Description

Glazed partition, constructions as part of the building envelope, which generally consists of horizontal and vertical profiles that are joined together, is anchored to the structure of the building.

It fulfils all the required functions of wall or part thereof. partitions are designed as self-supporting constructions

## Specifications

Construction	Mechanically formed special narrow profile
Materials	Cold rolled Galvanized Steel sheet confirms to ASTM or equivalent standards
Size	3000x 3000mm overall – no limits in width
Core Or Insulation	Fully Glazed – No core
Glass	Fire rated glass – confirms to E and EW requirement
Frame Profiles	Mechanically formed special narrow profile
Ironmongery	Tested and Certified as per door test standard BS and EN
Fire Rating	E 180 minutes - EW 120 Minutes
Test Standard	EN 1364-1/BS476 part20-22
Certification	Intertek, Exova Warrington
Finish	Powder coated/ Wood finish/ meets ANSI A 250.3 and ANSI A 250.10

## Additional Features

- Alternate Stainless-steel material
- No limitation in width, height can be replicate by a separator
- Glazed panes are separated with same profiles
- Alternate glass specification
- Smoke rated as per UL1784 / BS476 section 31.1/ BSEN 1634-3
- Acoustical





### Description

Special designed fire rated butt joint system which eliminates intermediate vertical mullions. Available with both Integrity and Insulation with impact and safety rated glass.

### Specifications

<b>Construction</b>	Specialty designed narrow Perimeter profiles with resistive infill
<b>Materials</b>	Cold rolled galvanized steel sheet confirm to ASTM or equivalent standard
<b>Sheet Thickness</b>	Making profiles with 1.5mm thick sheet
<b>Glass</b>	Fire rated glass for both Integrity and insulation application- joint together with special intumescent strips
<b>Application</b>	Interior
<b>Fire Rating</b>	EI 60 minutes (E-Integrity and I- Insulation)
<b>Test Standard</b>	EN 1364-1/ BS 476 part20-22
<b>Certification</b>	Intertek, Exova Warrington
<b>Finish</b>	Powder coated/ Wood finish/ Wet paint meets ANSI A 250.3 and ANSI A 250.10

### Additional Features

- Alternate Stainless-steel material
- No limits in width
- Meeting joint with intumescent can be replace with verticle steel mullions
- Smoke rated as per UL1784 / BS476 section 31.1/BSEN 1634-3
- Approved by all Civil defense
- Acoustical

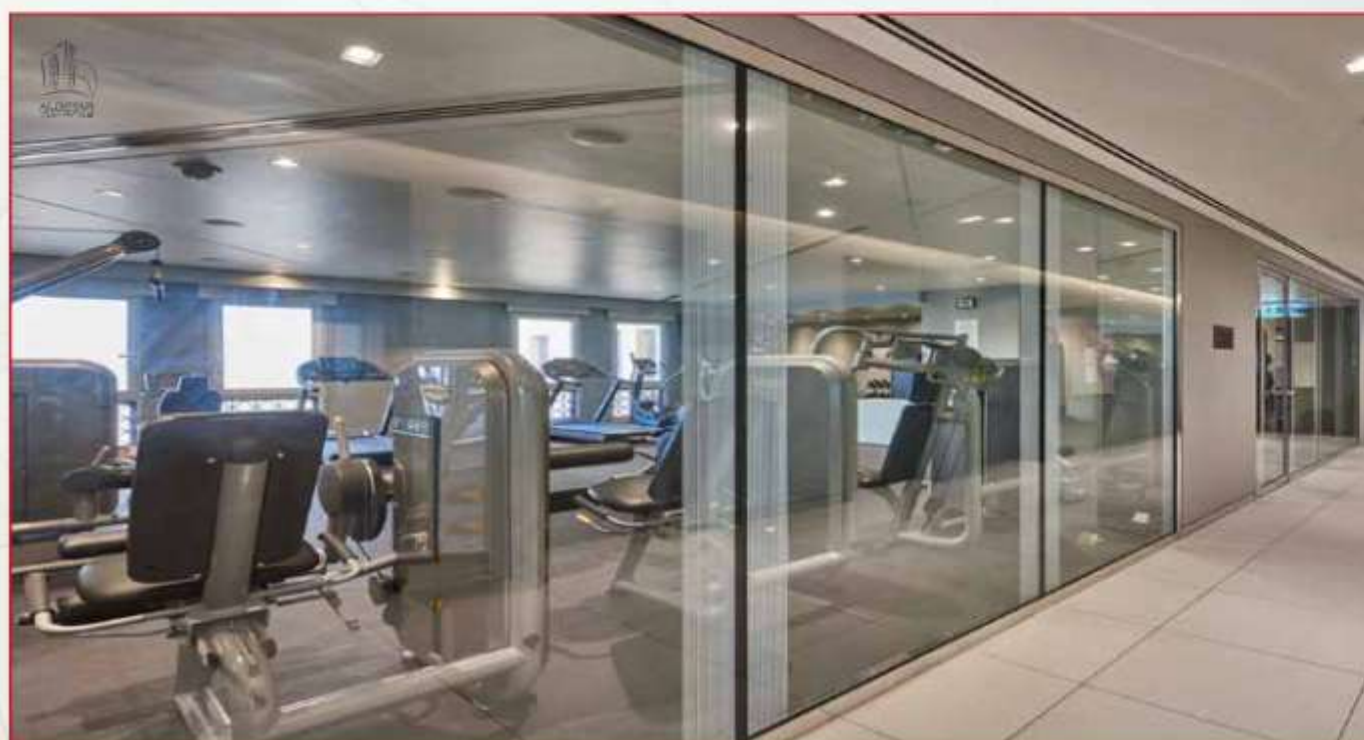

## Fully Glazed Butt Joint System- Integrity and Insulation





## Description

Curtain wall, constructions as part of the building envelope, which generally consists of horizontal and vertical profiles that are joined together, is anchored to the load bearing structure of the building and fitted with fixed infills and /or infills which can be opened.

It fulfils all the required functions of inner or outer wall or part thereof.

Curtain walls are designed as self-supporting constructions which transfer the dead load, dynamic loads, loads from the surroundings (wind, snow etc.) and seismic loads to the main structure of the building.

Fire rated curtain wall system is a modular façade construction for universal use. The system is suitable for vertical system with fire rating Integrity and radiation (E and EW) 120 minutes

## Specifications

Construction	Mechanically formed special narrow profile from Jansen
Materials	Cold rolled galvanized steel sheet confirm to ASTM or equivalent standard
Profile	Rectangular profile with skin thickness 1.2 to 1.8 mm
Size	3000x 3000mm (wxh) and no limitation in width
Core Or Insulation	Fully glazed- thermally insulated
Glass	Fire rated glass –confirms to EW requirement
Application	Light to extra heavy duty use as per SDI
Frame Profile	Mechanically formed special narrow profile from Jansen
Ironmongery	Tested and Certified as per door test standard BS and EN
Fire Rating	EW 120 minutes
Test Standard	EN 1-1364/ BS 476 part22-20
Certification	Intertek, Exova Warrington
Finish	Powder coated/ Wood finish/ Wet paint meets ANSI A 250.3 and ANSI A 250.10

## Additional Features

- No limitation in width, height can be replicate by a separator
- Glazed panes are separated with stiles and rails
- Smoke rated as per UL1784 / BS476 section 31.1/BSEN 1634-3
- Acoustical

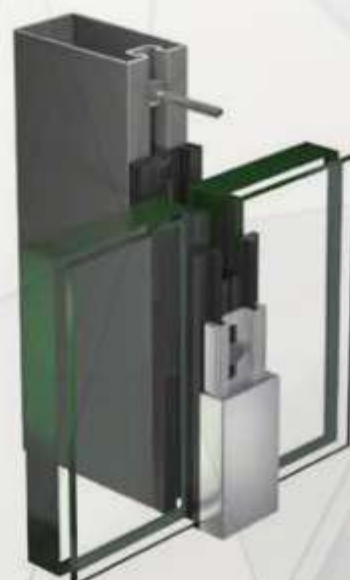



## Description

Alternative to steel doors and partition system, special designed fully glazed aluminum fire rated system. Narrow stiles and rails with concealed hardware for good austenitic view, increased glazed area, slimmer thermal break profile, suitable integrity and insulation application with special fire resistive infill.

## Categories

- Aluminium Glazed Double Doors (E, EW, EI)
- Aluminium Glazed Partitions (E, EW, EI)
- Aluminum Fully Glazed Doors With Side And Transom Panels (E, EW, EI)



Angle joint of the fixed walls 90

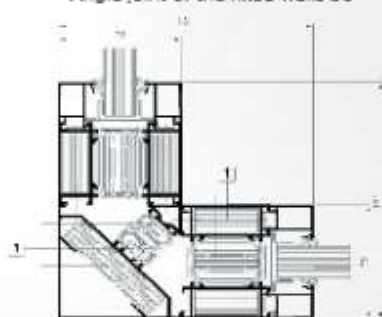

Angle joint of the fixed walls



Door without a threshold - bottom cross-section



Door frame and door leaf - cross-section

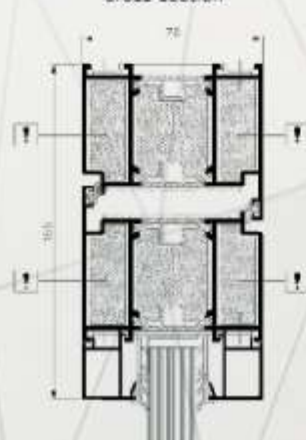

Door leaf with drop seal - cross-section

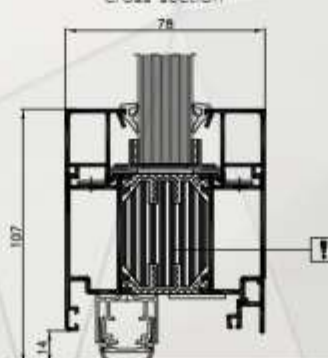



## Description

Bullet resistance doors and windows are designed to provide protection by preventing the passage of projectile at different threat levels and protect personnel against injury.

Doors and windows are suitably reinforced as required by UL and EN test criteria. Each Level have the different thickness of reinforcement and glass thickness.

## Specifications

<b>Construction</b>	<b>Mechanically interlocked, hemmed vertical edge seam with inverted top and bottom channel welded to both face sheets /special designed windows</b>
Bullet protection sheets	Thickness of protection plates are depending on threat levels as per UL and EN
<b>Materials</b>	<b>Cover sheet is Cold rolled galvanized steel sheet confirm to ASTM or equivalent standard</b>
Gauge/Door thickness	45-80mm thick door with Cover skin thickness 2mm+ Bullet proof protection sheet as per Threat level
<b>Core or insulation</b>	<b>Honeycomb with Ballistic Sheet</b>
Frame gauge/Jamb depth	2mm up to 500mm- No limits
<b>Test Standard</b>	<b>UL752, EN 1522/1523 and Glass as per EN 1063</b>
Levels	UL752 Level-3 and Level 8 doors and windows, FB4 and FB6 doors and windows
<b>Finish</b>	<b>Powder coated/ Wood finish/ meets ANSI A 250.3 and ANSI A 250.10</b>

Bullet resistance doors and windows. UL and EN

## Additional Features

- Seamless welded design
- Vision panel
- Alternate Stainless-steel material
- Knock down frame /Groove frame with kerf gasket
- Smoke rated as per UL1784 / BS476 section 31.1/BSEN 1634-3
- STC rated

## Typical application areas are

1. Embassies
2. VIP Offices
3. Guard House
4. Cashier Rooms
5. Bank court houses
6. Military buildings
7. Control rooms
8. Cashier area
9. Jewelry shops & ETC.





## Description

Security steel doors and windows with security glazing frames are used in detention and correctional facilities. constructed with special design and hardware to prevent the security against inmate tampering attack by variety of tools.

## Technical Details and Additional feature cover

- Food pass
- Door sheet thickness minimum 2.3 mm
- Door thickness 55 mm / vary based on design
- Internally welded Vertically stiffened with high density rockwool
- Freely welded edges with special reinforcements
- Top and bottom channel with additional flush closing channel equal to the door minimum thickness
- Frame sheet thickness minimum 2.3 mm
- Fully welded cover joints

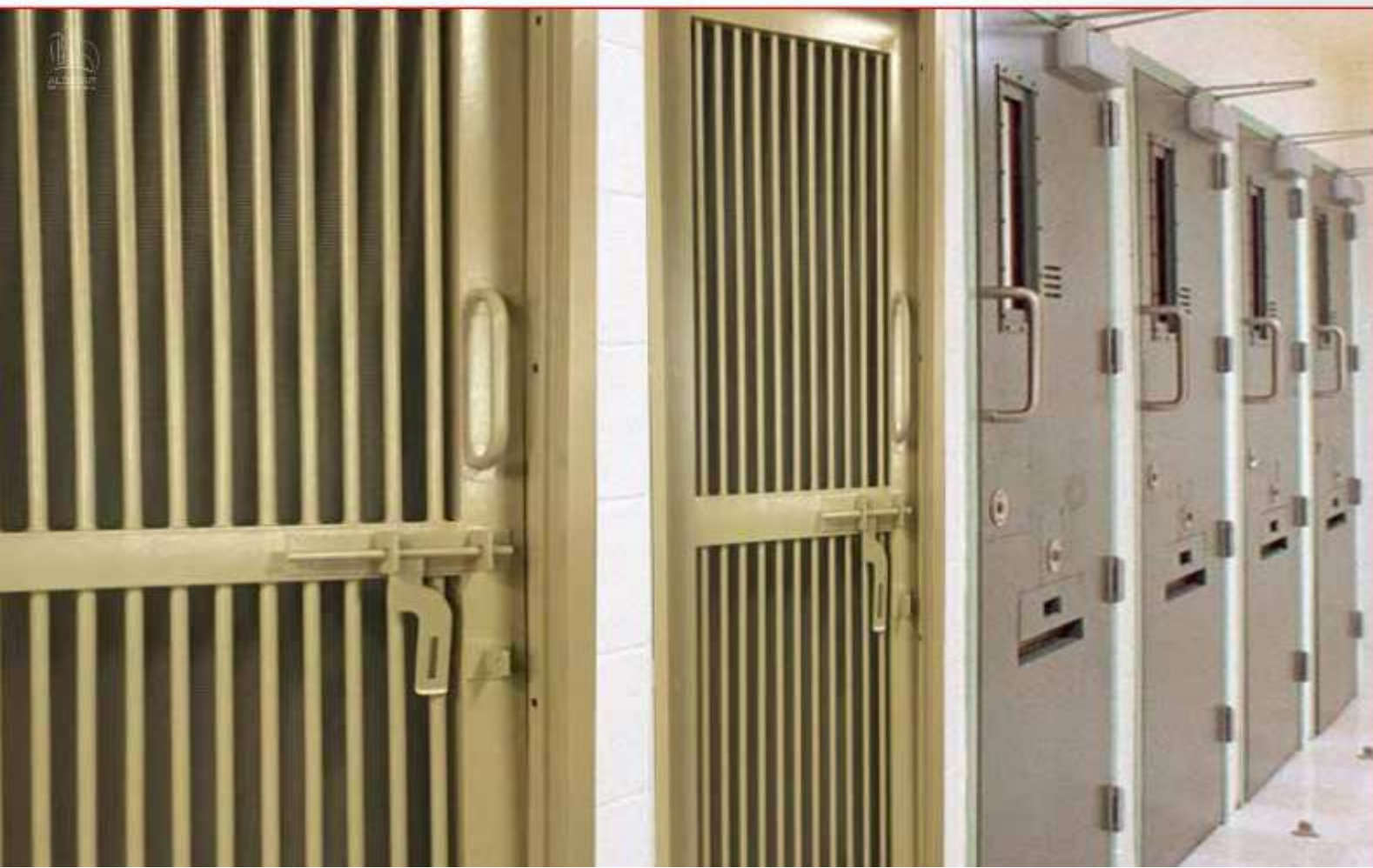



## Description

Garbage and Linen chute door also known as "Centralized Garbage Collection System" provides an efficient and hygienic method of garbage disposal in types of residential and commercial buildings. It can be easily be installed in any duct, common lobby, landing, staircase, midlanding, utility duct, dry balcony and kitchen.

### Advantages of Garbage Chute

- Garbage can be disposed anytime and multiple times a day.  
Hence no need to accumulate dirty and unhygienic garbage
- Garbage from all the floors gets collected at single point
- Manpower cost is saved
- "Dry" and "Wet" garbage segregation also possible.
- Reduces power consumption

## Specifications

<b>Construction</b>	Custom design door and frame assembly with LED indicator. Spring loaded
<b>Materials</b>	Cold rolled galvanized steel sheet confirm to ASTM or equivalent standard
<b>Gauge/Door Thickness</b>	40mm thick door with skin thickness 1.5-1.2mm
<b>Application</b>	Variety of Ducts, Common lobbies, landing, staircase, utility ducts, for Residential buildings, Hotels, Hospitals
<b>Frame Gauge</b>	1.2 and 1.5 mm
<b>Ironmongery</b>	Certified as per door test standard BS,
<b>Fire Rating</b>	Up to 180 minutes as per BS 476 part22-20
<b>Test Standard</b>	BS 476 part22-20
<b>Certification</b>	BM trada
<b>Finish</b>	Powder coated/ Stainless steel

Garbage and linen door.

## Additional Features

- Seamless full flush design
- Easy installation and maintenance
- Smooth operation
- Factory assembled
- Intake is via stainless steel/Powder coated galvanized hand operated side hinge door with 180 degree opening for easy operation
- Alternate Stainless-steel material





### Description

Overhead sectional doors are the ideal solution for all Industrial and logistic needs. The design and different solutions ensure the door to be aesthetically pleasing and perfectly suited in any architectural environment from modern to traditional buildings.

These doors are built to ensure the highest ease and flexibility of use which, in turn, ensure a quick hassle-free operation. Their compact size ensures more available space both inside and outside the premises.

Depending on the structural of the building and the requirement a choice can be made from a

- Standard Lift
- Vertical lift
- Horizontal lift
- Low head room or inclined lift

### Features

- Reliable and low noise operation
- Extreme robustness
- Safe operation in compliance with safety requirements
- Design oriented surfaces and optimum light solution
- Installation friendly

### Technical details

- Panels are sturdy and consists of double skinned pre-painted galvanized sheet with thickness 40mm
- Core insulated with high density polyurethane with CFC free offers high protection from out side temperature
- Available with Maximum width of 15 meters and height of 10 mts



### Description

Rolling shutters are ideal application for conventional store front and security reasons.

Our Rolling shutter are durable and designed for Industrial, Commercial, Residential and Security application for both internal and external requirements.

Fire rated Rolling Shutters are rated physical fire barrier that protect wall opening from spread of fire and are designed to close automatically in the event of fire or an alarmed event. Automatic closure will be thermally controlled by means of Fusible link.

- Fabricated of interlocked galvanized sheets.
- Required low head room space above the structural opening and solidly constructed to promote trouble free operation and long life.
- Electrically operated shutters are fitted with a geared motor complete with a Push button with UP, Down, and Stop buttons.
- Rolling shutter can also be designed as per client specifications
- Fire rated up to 240 minutes as per BS 476 part20-22 standard.
- Finish as per Client requirement from the RAL color chart.

### Features

- Manually operated
- Electrically operated
- Three station push button control switch
- Many additional features based on client's request

### Construction

Fabricated from single skin galvanized or galvalume sheet curved shape with side guides and supports with MS angles and Hood cover.

### Applications

- Factories
- Schools
- Hospitals
- Commercial
- Residential areas



Three-phase LP650TC  
Override options  
Emergency manual operation types

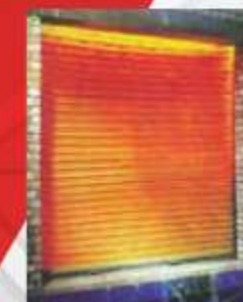

Shutter after 2 hours test





## Description

We are pleased to introduce ourselves as Al Osool Bldg. Metallic Const. Ind. LLC located in Industrial Area 13, Sharjah.

We are manufacturing a wide range of Fire Cabinets. We are making all types of Fire Cabinet like Fire Hose Reel Cabinets, Fire Extinguisher Cabinets, Fire Hose Cabinets, Breeching Inlet Cabinets. We Supplied to UAE, Oman, Bahrain, Saudi Arabia, Egypt, Sudan Jordan etc. We can produce any type of fire cabinets as per the client's requirement.



## Full Mild Steel Cabinets

Dimension	Any size as per. requirement
Material	Mild steel / G.I
Thickness	1.5/1.2/1 mm / 2.0 mm - up to 3 mm
Installation	Surface / Wall Mounted, Or recessed type
Capacity	Manual or Automatic swing, fixed hose reel 4/3" or 1"
Finish	Red powder coated, Any Colors

## Full Stainless Steel Cabinets

Dimension	Any size as per. requirement
Material	Stainless steel / / Mild steel / G.I / 304 G / 316 G
Thickness	1.5/1.2/1 mm / up to 3 mm
Installation	Surface / Wall Mounted, Or recessed type
Capacity	Manual or Automatic swing, fixed hose reel 4/3" or 1"
Finish	S.S., Mirror Finish, Brush Finish, Hair line

## Recessed Type Cabinets with Stainless Steel Facia

Dimension	Any size as per. requirement
Material	Stainless steel / / Mild steel / G.I
Thickness	1.5/1.2/1 mm / up to 3 mm
Installation	Surface / Wall Mounted, Or recessed type
Capacity	Manual or Automatic swing, fixed hose reel 4/3" or 1"
Finish	S.S., Mirror Finish, Brush Finish, Hair line with RP BB Back Box





Attractive, affordable, low maintenance and easy to install Hand rails for residential and commercial applications.

The design is extremely durable and meet with all customer requirements.

They are available in custom design and shapes in Stainless steel and Mild steel with the below shapes.

- Straight
- Straight with Flare
- Spiral
- Curved



Steel powder Coating



Stainless Steel



Ladder

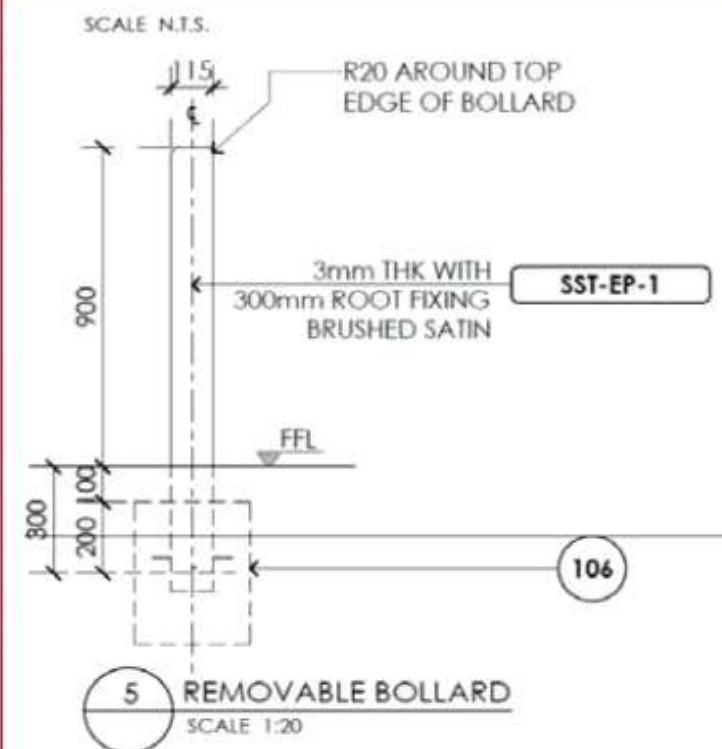

REFERENCE IMAGE

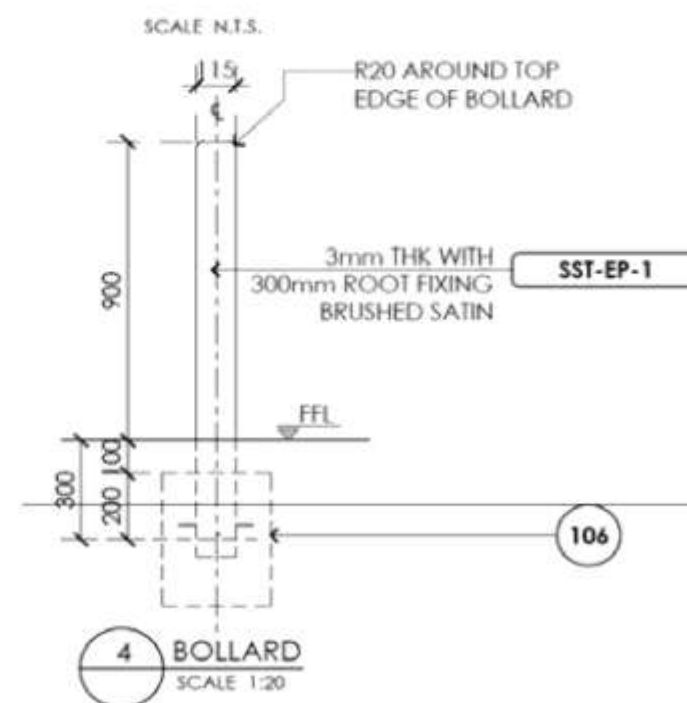

REFERENCE IMAGE



At Al Osool, we are equipped to offer Fire Doors tested and certified to British Standards, European standard/ UL standard the significant requirements of this standards are listed below.

## British Standards

BS 476, Parts 20 & 22.

- A fire door **MUST** be self-closing. Only the active door leaf of an access panel (service ducts) or cupboards, can however be installed without a closer but with a dead lock and a "Fire Door, Keep Shut" sign placed clear on the door face.
- Unless shown to be satisfactory when tested as part of a fire door assembly, the components on which the door is hung should be fire rated.
- If a fire door is held open, it must be equipped with a tested, automatic release mechanism actuated by an automatic fire detection and alarm system, fusible link (not if door is fitted in an opening provided as means of escape), or a door-closed delay device.
- Signs and other items of hardware containing plastic should not be fitted on the non-fire side of the metal door or frame

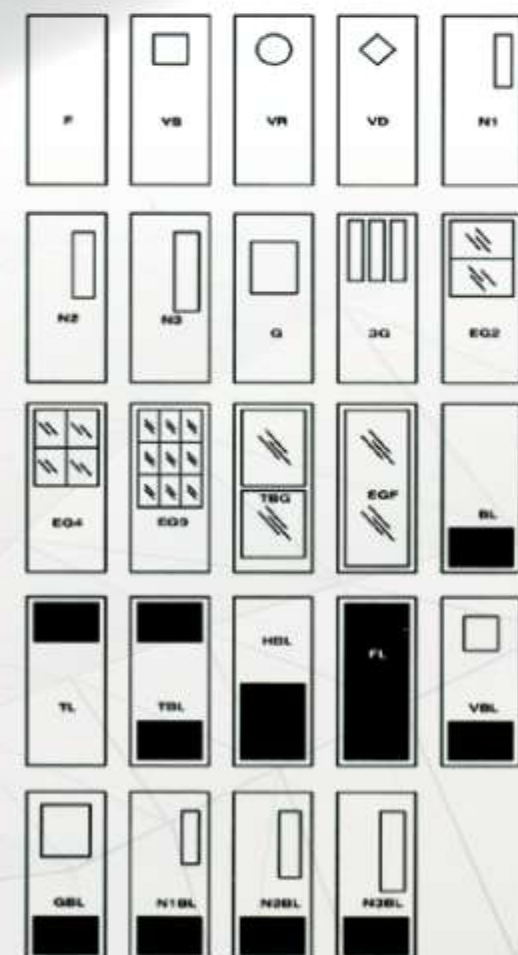

Basics	
F	Full flush
VS	Vision small
VR	Vision round
VD	Vision diamond
N1	Narrow lite
N2	Narrow lite
N3	Narrow lite
G	Half glass
3G	3 Glass
EG2	Etched glass 2 section
EG4	Etched glass 4 section
EG9	Etched glass 9 section
TBG	Top & bottom glass
EGF	Etched glass full
BL	Bottom louver
TL	Top louver
TBL	Top bottom louver
HBL	Half bottom louver
FL	Full louver
VBL	Vision + bottom louver
GBL	Half glass with bottom louver
N1BL	Narrow lite
N2BL	Narrow lite with bottom louver
N3BL	Narrow lite



For this, the door must serve as a fire and smoke barrier.

Studies have shown that more people have lost lives due to smoke asphyxiation than fire.

Fire Doors must serve four main functions

- serve as a regular door at all times and provide ready egress from a fire area during a fire
- inhibit spreading of fire
- protect life and property by reducing smoke hazards.

When an opening requires strength, durability, or maximum fire resistance, steel doors and frames provide the qualities to meet these needs. Due to growing access control needs, fire doors have today evolved to accommodate the growing electrified functions a door must support.

Designed to meet the life-safety requirements in various types of buildings and structures, Al Osool fire doors help in containing the spread of fire. These doors complement existing passive fire-fighting systems.

These doors also meet all the stipulated international, national and regional fire safety standards. These doors are available with honeycomb core as standard infill material with other optional cores. These doors are rated for 45, 60, 90, 100, 120, 180 & 240 minutes' fire withstanding ability. All fire doors are factory finished with Powder coating.

## Applications

These doors can be used in high-rise buildings, metro railway stations, telecom centers, power plants, cellular network stations, garment processing units, shopping malls, industrial plants, multiplexes, hotels, auditoriums, software parks, restaurants, warehouses and labor camps etc. Al Osool doors and frames are designed to perform in the most demanding environment.

## Warranties

All our products carry a warranty of 1 year against manufacturing defects.

## Features

- Available in galvanised or stainless steel
- BMTRADA, WARRINGTON CERTIFIER & INTERTEK certified labeled doors for 60, 120, 180 & 240 minutes
- Clear vision Panel for up to 240 minutes' fire rating
- No welding joints and sharp edges, interlocking at the stiles
- Factory prepped to receive all types of hardware
- High aesthetics and robust structure
- Fully flush constructions
- Easy to install on a flush wall opening & dry wall partitions
- Factory finished for primer and paint finishes.

## Standards and Certifications

- Fire doors are tested as per BS/EN and UL standards

## Optional Features

- Wood Grain can be provided as an optional finish.

## Matching appearance

Al Osool advises Door leaf, Frames and components from one Source!





Universal handing of Doors according to UAE reading conventions

*Single leaf door*

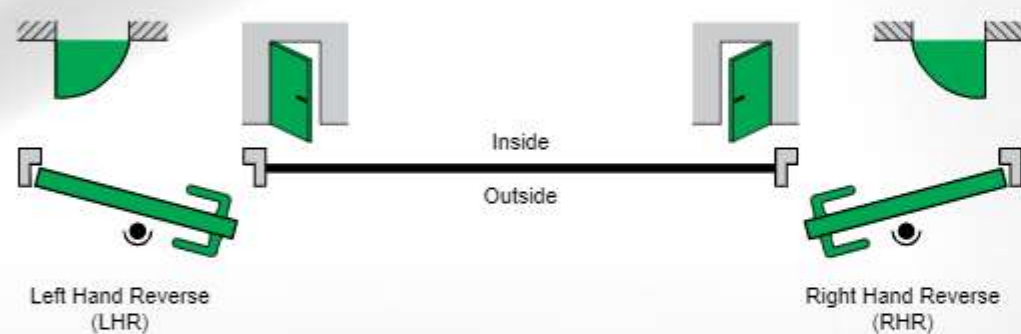
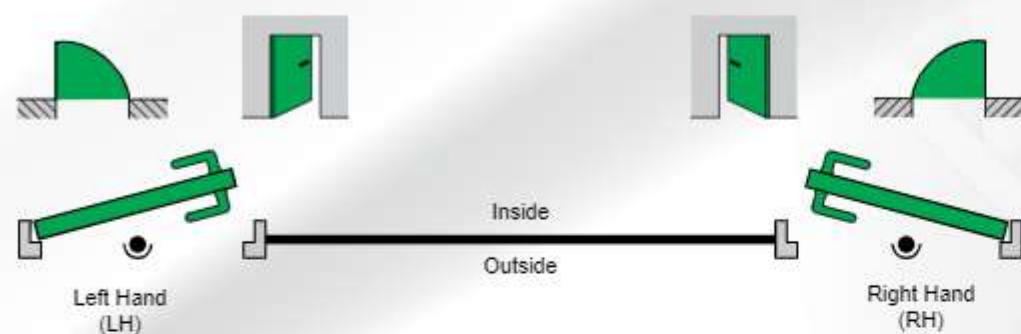

*Double leaf door*

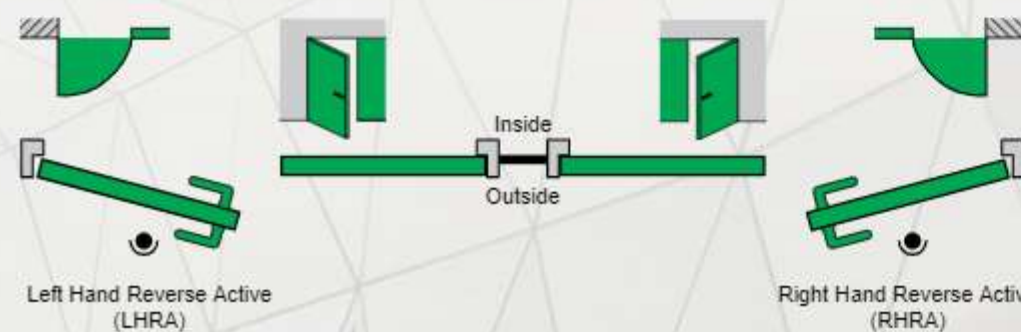
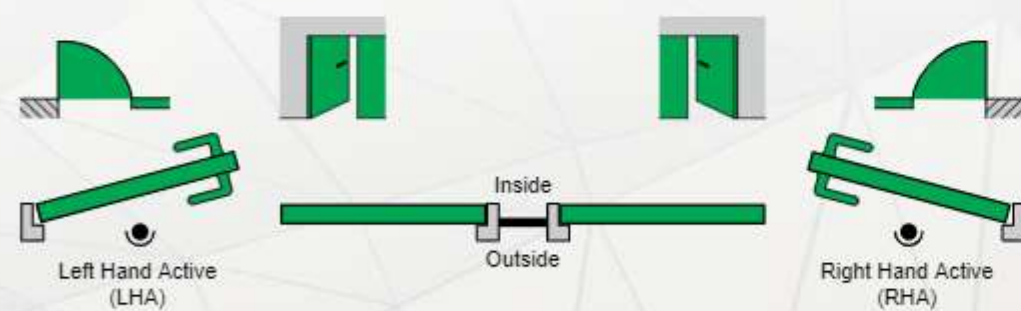

RAL 1000	RAL 2000	RAL 3000	RAL 4001	RAL 5000	RAL 6000	RAL 7000	RAL 8000	RAL 9001
RAL 1001	RAL 2001	RAL 3003	RAL 4002	RAL 5001	RAL 6001	RAL 7001	RAL 8001	RAL 9002
RAL 1002	RAL 2002	RAL 3004	RAL 4003	RAL 5002	RAL 6002	RAL 7002	RAL 8002	RAL 9003
RAL 1003	RAL 2003	RAL 3005	RAL 4004	RAL 5003	RAL 6003	RAL 7003	RAL 8003	RAL 9004
RAL 1004	RAL 2004	RAL 3017	RAL 4005	RAL 5004	RAL 6004	RAL 7004	RAL 8004	RAL 9005
RAL 1005	RAL 2012	RAL 3020	RAL 4006	RAL 5005	RAL 6015	RAL 7005	RAL 8007	RAL 9010
RAL 7005	RAL 7006	RAL 7008	RAL 7009	RAL 7032	RAL 7033	RAL 7034	RAL 7035	RAL 7036
RAL 7037	RAL 7038	RAL 7039	RAL 7034	RAL 7042	RAL 7040	RAL 7044	RAL 7045	RAL 7046







**TOUCH BAR PANIC LATCH**



**TOUCH BAR PANIC BOLT**



**VERTICLE PUSH BAR**



**PUSH PLATE SIGN**



**EXTERNAL LEVER TRIM**



**SAFETY LEVER**



**PUSHPAD LATCH**



**DOOR CLOSER**



**CONCEALED DOOR CLOSERS**



**DOOR CO-ORDINATOR**



**SASH LOCK**



**FLUSH BOLTS**



**ALLEN KEY LOCK**



**CYLINDER & TURN**



**DOUBLE CYLINDER**



**DUST SOCKET**



**DOOR STOPPER**



**BALL BEARING HINGES**



## Operation Headquarter



**ALOSOOL BLDG. METALLIC CONST. IND. LLC.**

📍 Industrial Area 13 - Sharjah - UAE

☎ +971 6 538 55 72 📠 +971 6 538 40 45

📍 47632 Sharjah - United Arab Emirates

✉ info@alosooluae.com 🌐 www.alosooluae.com



UAE Branch

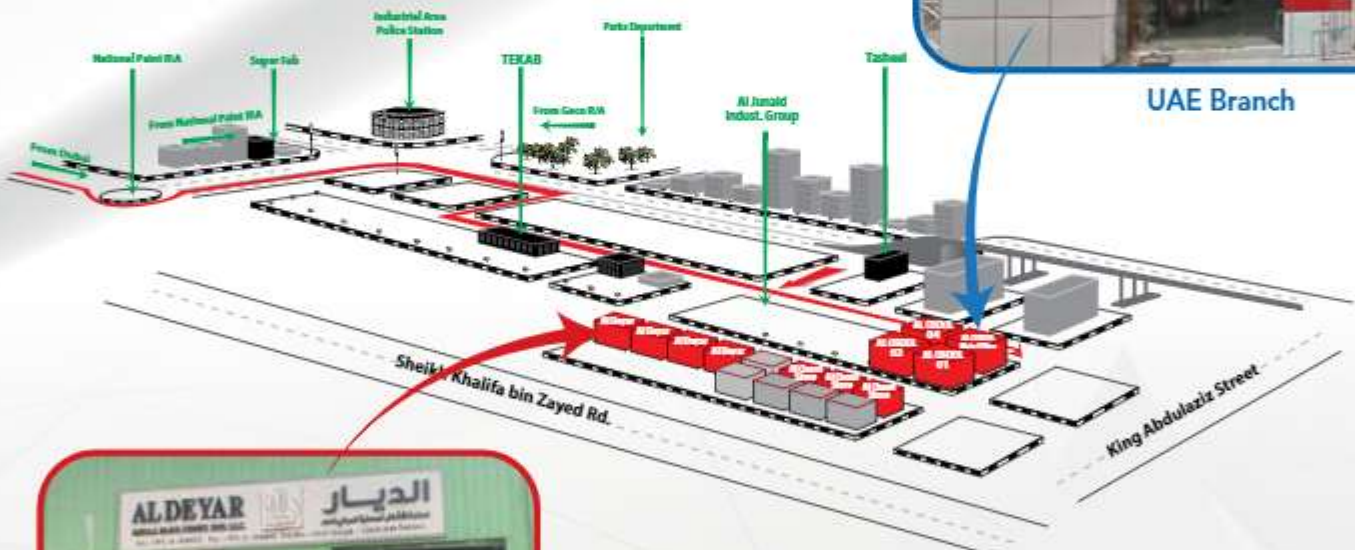

## Manufacturing Headquarter



**ALDEYAR METAL BLDG. CONST. IND. LLC.**

📍 Industrial Area 13 - Sharjah - UAE

☎ +971 6 747 09 95 📠 +971 6 747 09 92

📍 83867 Sharjah - United Arab Emirates

✉ sales.d.steel@gmail.com 🌐 www.aldiar-jo.com