

# COREMETAL®

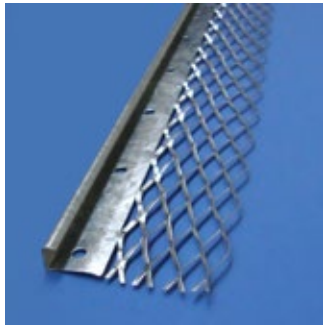

- EXPANDED METAL
- PLASTER BEADS
- LINTELS
- WALL TIES
- BUILDING COMPONENTS
- CEILING & PARTITION SYSTEM



## PRODUCT CATALOGUE



**Core Metallic Ind. L.L.C**  
Expanded Metal Division

ISO 9001:2015 | ISO 14001:2015 | OHSAS 18001:2007

COREMETAL® CorePac® Emboscal® ASMECO®  
[www.coreindustry.net](http://www.coreindustry.net)

# CONTENTS

## INTRODUCTION

### COREMETAL- PERFORMANCE GUARANTEED

Core Metallic Ind. llc is an ISO 9001 company and a leading supplier of structural steel products for the construction industry for a decade. Acknowledged for our excellence of service and conformance to the highest quality standards, our products are widely marketed in the Emirates and the other GCC Countries.

Building on our strength in the steel trading market, Core Metal L.L.C is now ventured in to the manufacturing and supply of a comprehensive range of building products such as Expanded Metal Products, Ceiling and Partition products and Cable Management Systems, branded **COREMETAL**. These are manufactured to the highest standards, complying all the relevant standards and specifications. Our state of the art machineries and a qualified work force bring out products that are of superior quality.

We are well equipped for meeting any market challenge with a very large manufacturing base and extensive range of machineries. Our ready stock of raw material assures the customer of unhindered supply of products. With continued product development **COREMETAL** is proud to deliver any quantity with excellent service and punctuality.

By Selecting **COREMETAL** brand you are rest assured that the product you have chosen are of superior quality and are fully supported by our trained technical and sales force.

## Key Drives

### Quality

We are committed with guaranteed performance for our products

### Ease of Use

Our products are designed with easy and accurate installation.

### Service

Our technical and sales team are well trained to cater your needs.

**Core Metallic Ind L.L.C**  
Crescent Tower, 5th Floor  
Buhairah Corniche, Sharjah, U.A.E

Office :- Tel. : +971 6 5013 111, Fax: +971 6 5540 619  
Factory :- Tel. : +971 6 5310 427, Fax: +971 6 5310 428

email: [em@coreindustry.net](mailto:em@coreindustry.net), web: [www.coreindustry.net](http://www.coreindustry.net)

## Block Work Accessories

Block Work Reinforcement .....	06
Horizontal Reinforcement Wire Mesh.....	06
Ladder / Truss Mesh .....	07
Corners and Tees .....	07
Lintels .....	08
Lintel Brackets .....	09
Wall Ties .....	10
Wall Ties Guide .....	13
Over head Restraints .....	14
Anchor Plates .....	14
Partition Top Anchors .....	15

## Plaster Work Accessories

Angle Beads .....	18
Micro Angle Beads .....	18
Plaster Stop Beads .....	19
Micro Plaster Stop Beads .....	19
Architrave Beads with Return Flange .....	20
Architrave Beads with Out Return Flange .....	20
Architrave Beads Double Sided Mesh .....	21
Movement Beads .....	21
Control Joint Beads .....	22
Render Stop Beads .....	22
Corner Mesh .....	23
Expanded Metal Lath .....	23
Sheet Lath .....	24
Strip Mesh .....	24
Coil Lath .....	25
Fiber Glass Plaster Reinforcing Fabric .....	26

## HI Rib Lath

Hi Rib Lath .....	30
Rib Lath .....	31

## Ceiling Furring & Dry Wall Partition System

Ceiling Furring system .....	34
Dry wall Partition system .....	35

Product Specification .....	36
-----------------------------	----

## CUSTOMER RELATIONSHIP MANAGEMENT

Through our group structures, we maintain our revolutionary approach to customer relationship management. Our method revolves around our customer who is assigned a Customer Relations Management ('CRM') executive from point of contact with us onwards. This CRM executive's sole purpose is to ensure customer delight, champion the voice of the customer and act as the progress hotline while ensuring clear information flow, feedback and review.

Not only is onsite support guaranteed through our project delivery structures, but our innovative flexible real-time response mechanism enables us to maintain the highest possible service levels by continuously assessing customers' dynamic needs and adapting our business accordingly to ensure market leadership.

## COREMETAL<sup>®</sup> GROUP

Coremetal Group is a leading UAE based integrated multi-disciplinary Construction & Industrial group employing over 1000 people across its operations in the UAE. For more than 15 Years, Coremetal has built a solid reputation in the Industrial market with an admirable track record of sustained growth and for delivering quality projects on time in both private and government sectors.

The company has a large team of top notch technical experts, specialized project management teams, a skilled multinational workforce and state-of-the-art technology along with an array of the latest sophisticated plants and machinery to ensure timely and successful completion of all projects.

Coremetal Group is horizontally integrated, and in addition to its core competence in construction, the Group has its strengths and competitive advantage by setting up group companies in allied sectors like Structural Steel, Metal Processing, Expanded Metal manufacturing, Machine Shop, Tube mills Manufacturing, Manufacturing and trading of disposable food packing items, Metal coating & Painting

The Coremetal Group of Companies have achieved certifications for ISO 9001, ISO 14001 and OHSAS 18001 for Quality, Environmental and Health & Safety Management respectively.

Coremetal is passionate about achieving excellence in all areas of its business, including its own processes and the products and services it provides to its customers. Coremetal has developed an integrated and systematic approach to quality, safety and the environment which is firmly focused on the customer and is geared towards developing excellence in every level of our businesses.

Coremetal places a huge premium on safety and believes that prevention of accidents and incidents, either relating to personnel injury, ill health and / or loss of company assets is essential to the safe and efficient operations of the Group. The Group safety policy is consistent with the requirements of OHSAS 18001: 2007, and commits Coremetal to comply with UAE & International statutory requirements. The Group ensures that all personnel undergo health and safety awareness training from arrival into the Group; this includes general awareness, site specific induction, pre-task information including risk assessment, and continual improvement.

Coremetal is a member of (LEED) leadership in Environmental Engineering Design; additionally we hold a responsible position as a Counsel Board Member of (EGBC) Emirates Green Building Counsel in regards to developing and implementing EUA standards that are related in the construction industry to promote a green built environment.

**COREMETAL<sup>®</sup> Emboscol<sup>®</sup> ASMECO<sup>®</sup> CorePac<sup>®</sup>**





# BLOCK WORK ACCESSORIES

- Block Work Reinforcement Mesh
- Horizontal Reinforcement Wire Mesh
- Ladder / Truss Mesh
- Corners and Tees
- Lintels
- Lintel Brackets
- Wall Ties
- Wall Ties Guide
- Over Head Restraints
- Anchor Plates
- Partition Top Anchors





## Block Work Reinforcement Mesh

Expanded Block Work Mesh is used to reduce cracking within brick and block masonry by adding tensile strength to the traditional construction method. When embedded in the mortar joint forms an integral structure of great tensile strength and resists stress, vibrations and thermal changes, minimizing the effect.

It is a length of expanded steel mesh with continuity and has no joints,welds or interweaving to fail under stress.Once mortared into brick work the mesh is immovable and cannot slip under tension.

As a general rule mesh should be set in the bed joints with its outer edge about 25mm from the face of the block work and should be used every second course of a wall. Combinations of different widths may be used to suit any wall thickness.

### Galvanized Steel

Reference	Size	Length(M)
GBM 075	75mm	100/50
GBM 100	100mm	100/50
GBM 125	125mm	100/50
GBM 150	150mm	100/50
GBM 175	175mm	100/50
GBM 200	200mm	100/50
GBM 250	250mm	100/50
GBM 300	300mm	100/50

### Stainless Steel

Reference	Size	Length(M)
SBM 075	75mm	100/50
SBM 100	100mm	100/50
SBM 125	125mm	100/50
SBM 150	150mm	100/50
SBM 175	175mm	100/50
SBM 200	200mm	100/50
SBM 250	250mm	100/50
SBM 300	300mm	100/50

- Other length and width also available on request

## Horizontal Reinforcement Wire Mesh

Masonry Horizontal Joint Reinforcement mesh is designed to be embedded in the horizontal mortar joints of masonry walls improving resistance to moisture penetration to reduce cracking from shrinkage or thermal stress.

It also bonds intersecting walls with higher strength and increases flexural strength and elasticity of masonry walls. The continuous deformation along side rods provide maximum adhesion to mortar. Horizontal Joint reinforcement Mesh includes Ladder Type and Truss Type.

## Ladder Type Mesh

Ladder Type Mesh consists of two parallel side rods with cross rods welded at 400mm, thus forming a Ladder Configuration and used where vertical reinforcement is present.

### Galvanized Steel

Reference	Size	Length(M)	Wire Dia
GLM 075	75 mm	3.0	3/4/5 mm
GLM 100	100 mm	3.0	3/4/5 mm
GLM 150	150 mm	3.0	3/4/5 mm
GLM 200	200 mm	3.0	3/4/5 mm

## Truss Type Mesh

Truss type Mesh consists of two side rods welded to a continuous diagonally shaped cross-rod forming a truss design with alternating welds not exceeding 200mm. This is used on single Wythe walls where vertical reinforcement is not present

### Galvanized Steel

Reference	Size	Length(M)	Wire Dia
GTM 075	75 mm	3.0	3/4/5 mm
GTM 100	100 mm	3.0	3/4/5 mm
GTM 150	150 mm	3.0	3/4/5 mm
GTM 200	200 mm	3.0	3/4/5 mm

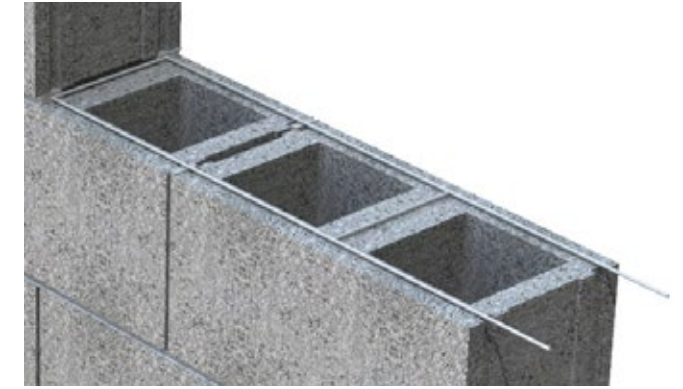

### Stainless Steel

Reference	Size	Length(M)	Wire Dia
SLM 075	75 mm	3.0	3/4/5 mm
SLM 100	100 mm	3.0	3/4/5 mm
SLM 150	150 mm	3.0	3/4/5 mm
SLM 200	200 mm	3.0	3/4/5 mm

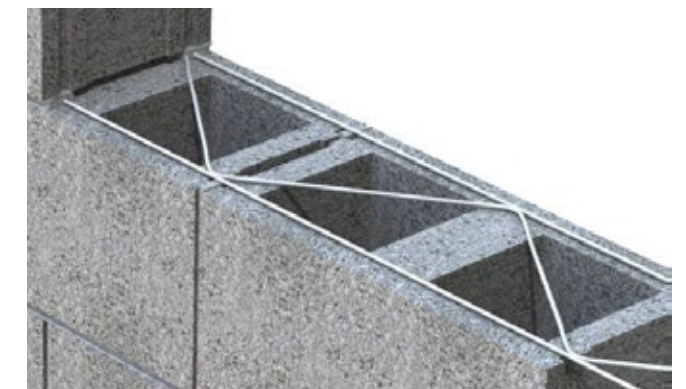

### Stainless Steel

Reference	Size	Length(M)	Wire Dia
STM 075	75 mm	3.0	3/4/5 mm
STM 100	100 mm	3.0	3/4/5 mm
STM 150	150 mm	3.0	3/4/5 mm
STM 200	200 mm	3.0	3/4/5 mm

## Corner and Tees

Corners and Tees are available for all sizes and thickness.

LADDER TEE	TRUSS TEE	LADDER CORNER	TRUSS CORNER
GLT(Galvanised)	GTT(Galvanised)	GLC(Galvanised)	GTC(Galvanised)
SLT(Stainless Steel)	STT(Stainless Steel)	SLC(Stainless Steel)	STC(Stainless Steel)

Various designs which are readily available at request :Width (mm) - 50, 100, 150, 200, 250

Wire Thk (mm) - 3, 4, 5

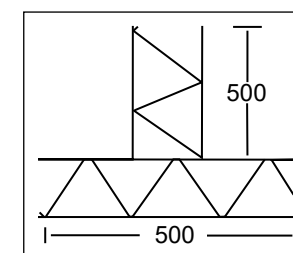

TRUSS TEE (GTT, STT)

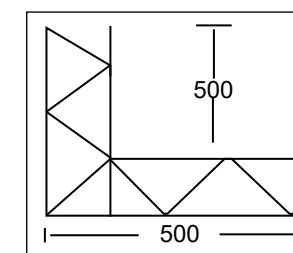

TRUSS CORNER (GTC, STC)

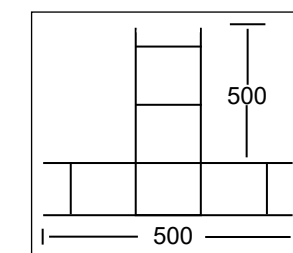

LADDER TEE (GLT, SLT)

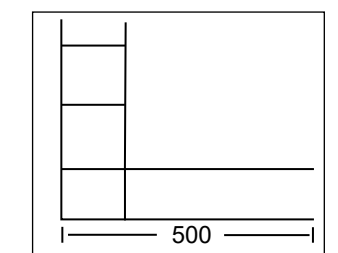

LADDER CORNER (GLC, SLC)

- Other Length and width also available on request



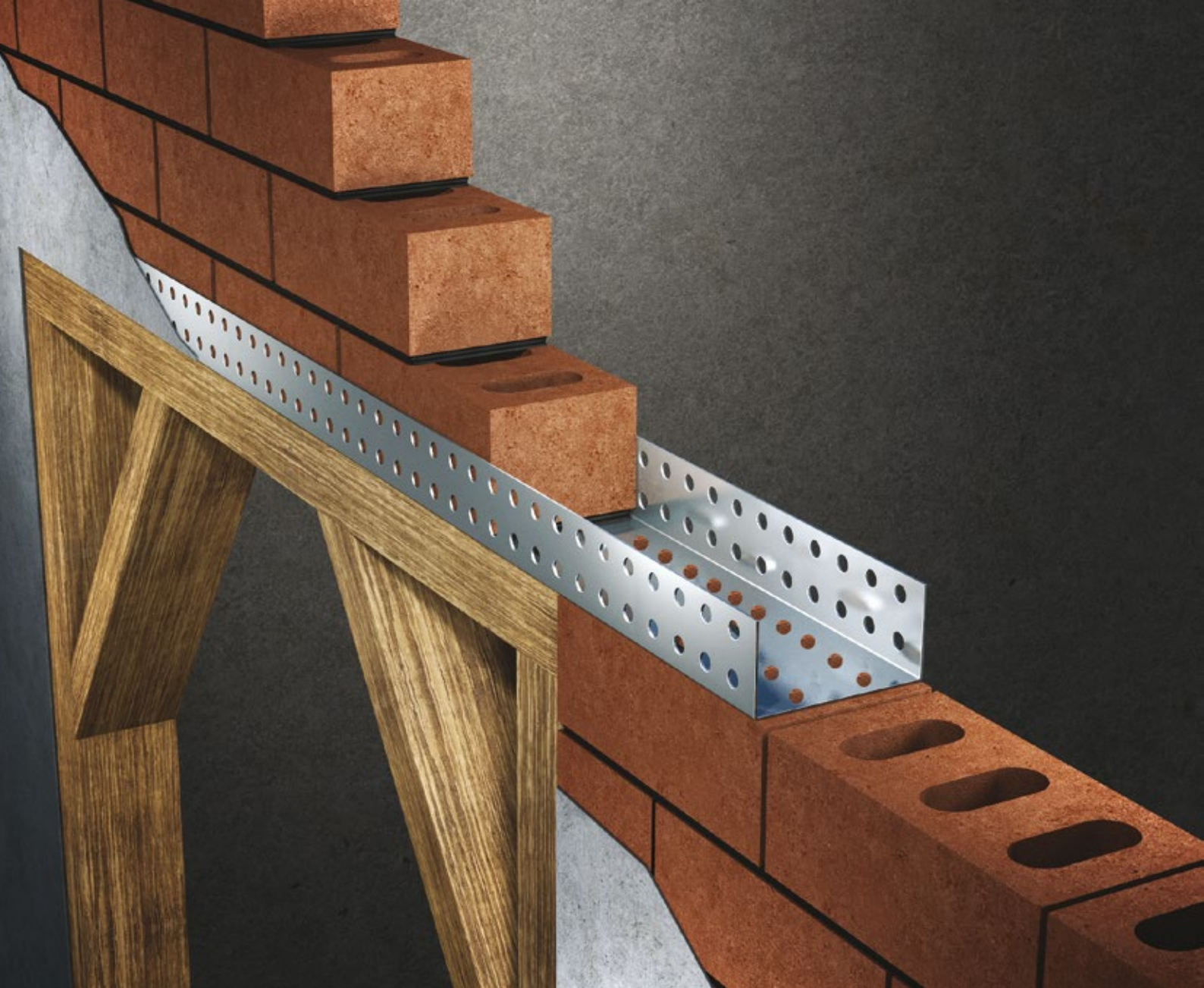

### Steel Lintels Load Calculations

Reference	Thickness Code	Thickness (mm)	Weight (Kg/m)	Flange (mm)	Width (mm)	0.90-1.20	1.30-1.50	1.60-1.80	1.90-2.10	2.20-2.40
						(Safe working Load (Tonnes))				
CL100-50	A	2.0	3.0	50	100	0.55	0.42	0.31	-	-
	B	2.5	3.7	50	100	0.80	0.58	0.38	0.24	0.18
	C	3.2	4.7	50	100	1.12	0.66	0.44	0.31	0.23
CL100-75	C	3.2	5.9	75	100	1.63	1.25	1.00	0.86	0.64
CL150-50	A	2.0	3.7	50	150	0.48	0.37	0.27	-	-
	B	2.5	4.7	50	150	0.76	0.58	0.41	0.27	0.19
	C	3.2	5.9	50	150	1.22	0.79	0.52	0.37	0.28
CL150-75	C	3.2	7.1	75	150	1.63	1.25	1.00	0.86	0.64
CL200-50	A	2.0	4.4	50	200	0.62	0.48	0.35	-	-
	B	2.5	5.6	50	200	0.77	0.59	0.41	0.29	0.21
	C	3.2	7.1	50	200	1.05	0.80	0.53	0.38	0.28
CL200-75	C	3.2	8.5	75	200	1.63	1.25	1.00	0.86	0.64
CL250-50	A	2.0	5.4	50	250	0.62	0.48	0.35	-	-
	B	2.5	6.7	50	250	0.77	0.59	0.41	0.29	0.21
	C	3.2	8.6	50	250	1.05	0.80	0.53	0.38	0.28

Note: Width dimensions are inside of channel dimensions. Special widths and thickness are available on request. Safe working loads are all given in the tables and substantiated by independent testing.

### Steel Lintels

Coremetal Steel Lintels provide open span support over window and door apertures with a combination of strength and light weight resulting in efficient load bearing performance and increased productivity on site.

All Lintels are manufactured to the highest quality standards in prime steel. In addition lintels can be further protected against corrosion by the addition of thermosetting powder coating or black dual coat epoxy painting.

Lintels are supplied with perforations as a plaster key. While installing ensure that a minimum 20cm end bearing is allowed at each side.

#### Features

- Efficient plaster key
- Easy to Use
- Cost Effective
- No delay in Block work

### Lintels Brackets

Brackets are supplied with fixing holes to suit various lintel widths.

Reference	Size (mm)	Thickness (mm)	Lintel Size	Anchor Size
CB100	100 x 150 x 150	4/5/6	CL100	4 x M8 x 80
CB150	150 x 150 x 150	4/5/6	CL150	4 x M8 x 80
CB200	200 x 200 x 150	4/5/6	CL200	4 x M10 x 80
CB250	250 x 200 x 150	4/5/6	CL250	4 x M10 x 80

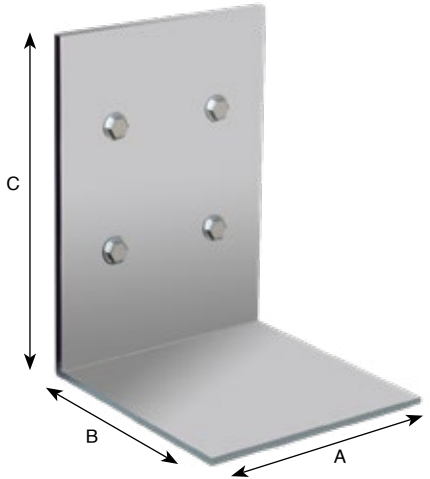



# Wall Ties

Wall Ties and Anchors are specially designed to secure wall skins and framework together to provide structural integrity through various forms of movement and force.A wide ranging choice of ties and fixings has been produced to provide the maximum performance for any combination of materials used in a project.

## 1.FRAME CRAMPS

Designed to restrain the masonry with vertical structures,frame cramps are produced in different shapes and sizes. Ties are provided with 6mm holes or 6x18mm slots as appropriate for fixing.

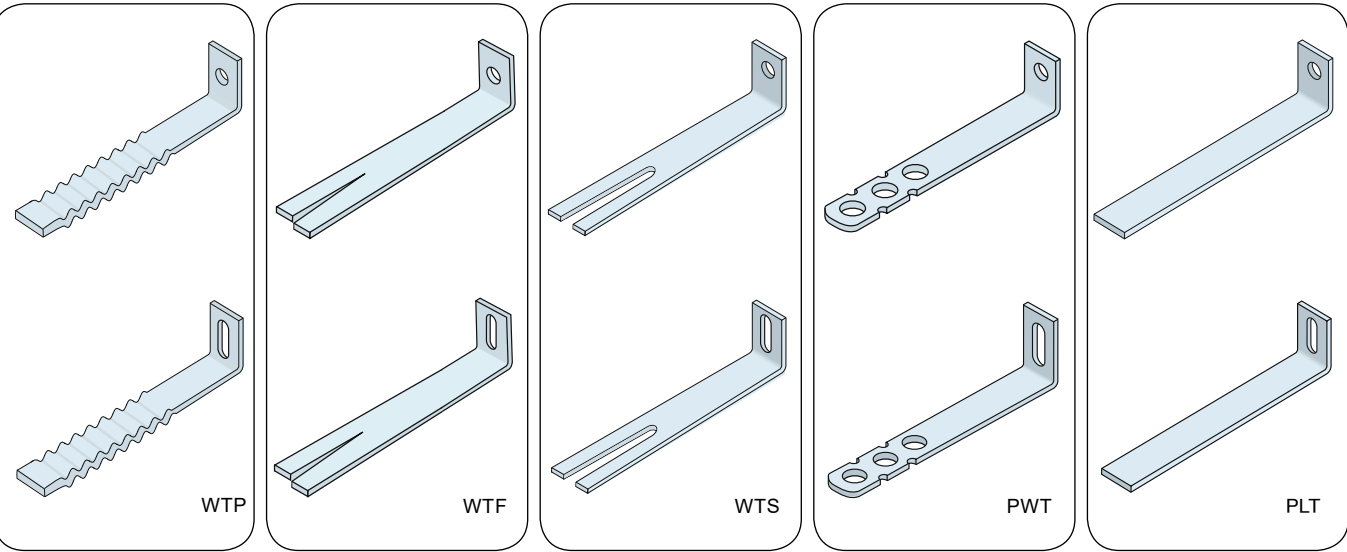

Length (mm)	Width (mm)	Upstand (mm)	Thickness (mm)	Material	Packing Pcs/Box
100	20/25/30/50	25/30/50	1.5/2.0/2.5/3.0/4.0	Galvanized/Stainless Steel	250
125	20/25/30/50	25/30/50	1.5/2.0/2.5/3.0/4.0	Galvanized/Stainless Steel	250
150	20/25/30/50	25/30/50	1.5/2.0/2.5/3.0/4.0	Galvanized/Stainless Steel	250
175	20/25/30/50	25/30/50	1.5/2.0/2.5/3.0/4.0	Galvanized/Stainless Steel	250
200	20/25/30/50	25/30/50	1.5/2.0/2.5/3.0/4.0	Galvanized/Stainless Steel	250
225	20/25/30/50	25/30/50	1.5/2.0/2.5/3.0/4.0	Galvanized/Stainless Steel	250
250	20/25/30/50	25/30/50	1.5/2.0/2.5/3.0/4.0	Galvanized/Stainless Steel	250
300	20/25/30/50	25/30/50	1.5/2.0/2.5/3.0/4.0	Galvanized/Stainless Steel	250
400	20/25/30/50	25/30/50	1.5/2.0/2.5/3.0/4.0	Galvanized/Stainless Steel	250

## 2.MOVEMENT TIES

Movement Ties are designed to restrain masonry against lateral wind loads,allowing a horizontal expansion or contraction and used where masonry restrained to steel work and in long span masonry. Ties are held in the brick work and the debonding sleeve in the plain end of the tie will allow the movement. A 10 mm gap is provided at the end between the tie and the sleeve in order to allow the expansion or contraction.

Ties are provided with 6mm holes or 6x18mm slots as appropriate for fixing.

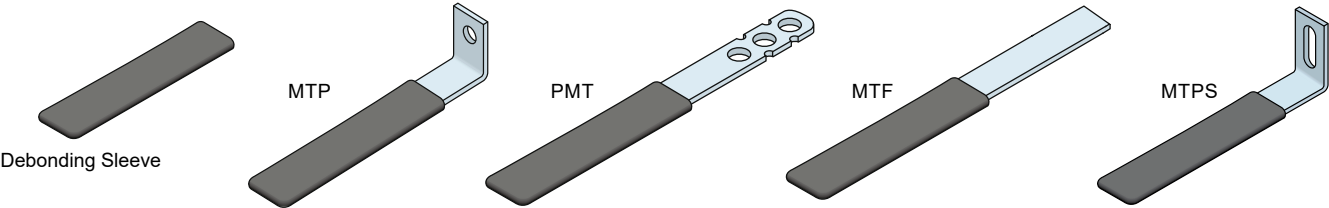

Length (mm)	Width (mm)	Upstand (mm)	Thickness (mm)	Material	Packing Pcs/box
100	25/50	30	1.5/2.0/2.5	Galvanized/Stainless Steel	250
150	25/50	30	1.5/2.0/2.5	Galvanized/Stainless Steel	250
200	25/50	30	1.5/2.0/2.5	Galvanized/Stainless Steel	250
225	25/50	30	1.5/2.0/2.5	Galvanized/Stainless Steel	250
250	25/50	30	1.5/2.0/2.5	Galvanized/Stainless Steel	250
300	25/50	30	1.5/2.0/2.5	Galvanized/Stainless Steel	250
400	25/50	30	1.5/2.0/2.5	Galvanized/Stainless Steel	250

- Other sizes and custom design ties are also available on request

3.CAVITY WALL TIES

Cavity wall ties are designed to secure two leaves of a cavity wall to each other allowing them to act as structurally one. These are made in strips or wires to be embedded in the masonry of two walls. The drip feature in the tie prevents the moisture travelling across the cavity. Ties are provided with 6mm holes or 6x18mm slots as appropriate for fixing.

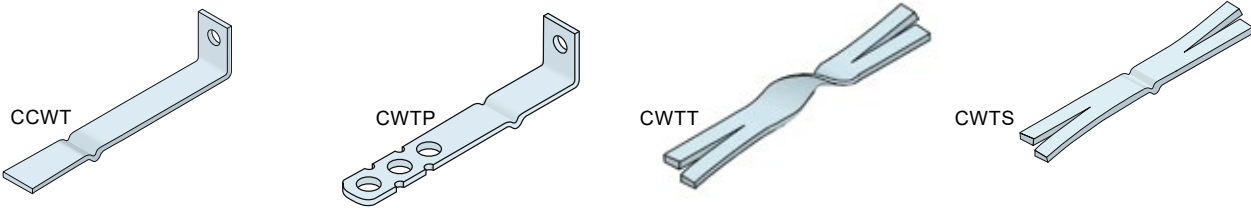

- Other sizes and custom design ties are also available on request

A.Strip Ties

Length (mm)	Width (mm)	Thickness (mm)	Material	Packing Pcs/box
150	20,25,30,40,50	1.5,2.0,2.5,3.0	Galvanized/Stainless Steel	250
200	20,25,30,40,50	1.5,2.0,2.5,3.0	Galvanized/Stainless Steel	250
225	20,25,30,40,50	1.5,2.0,2.5,3.0	Galvanized/Stainless Steel	250
250	20,25,30,40,50	1.5,2.0,2.5,3.0	Galvanized/Stainless Steel	250
300	20,25,30,40,50	1.5,2.0,2.5,3.0	Galvanized/Stainless Steel	250

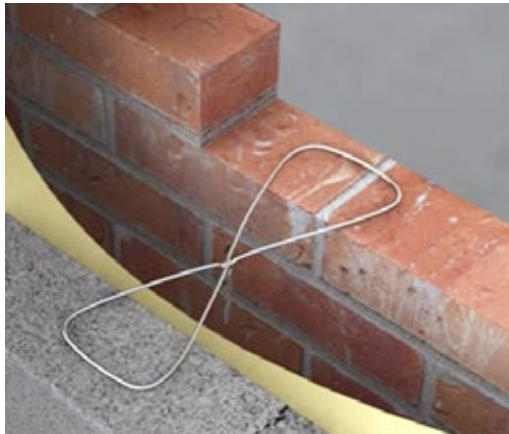
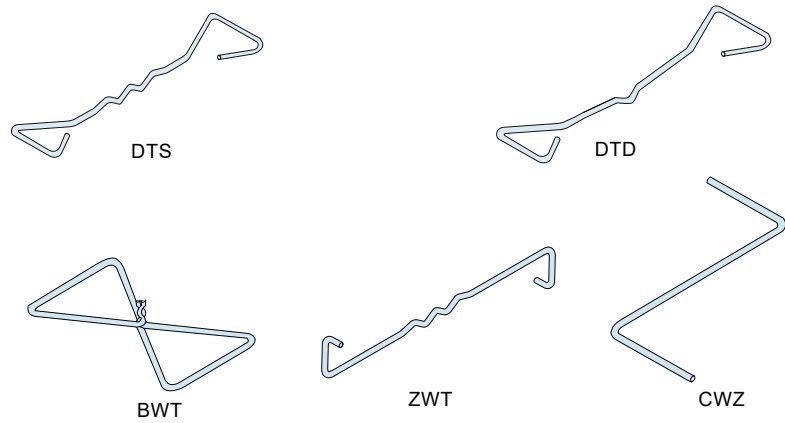

B.Wire Ties

Reference (mm)	Length (mm)	Wire Size (Dia mm)	Material	Packing Pcs/box
BWT	150/200/250/300	3.0,4.0,5.0	Galvanized/Stainless Steel	250
DTS	150/200/250/300	3.0,4.0,5.0	Galvanized/Stainless Steel	250
DTD	150/200/250/300	3.0,4.0,5.0	Galvanized/Stainless Steel	250
ZWT	150/200/250/300	3.0,4.0,5.0	Galvanized/Stainless Steel	250
CWZ	150/200/250/300	3.0,4.0,5.0	Galvanized/Stainless Steel	250

- Other Length and width also available on request

Wall Ties Guide

Different combinations are available from below list to suit customers practical applications.

Tail Options

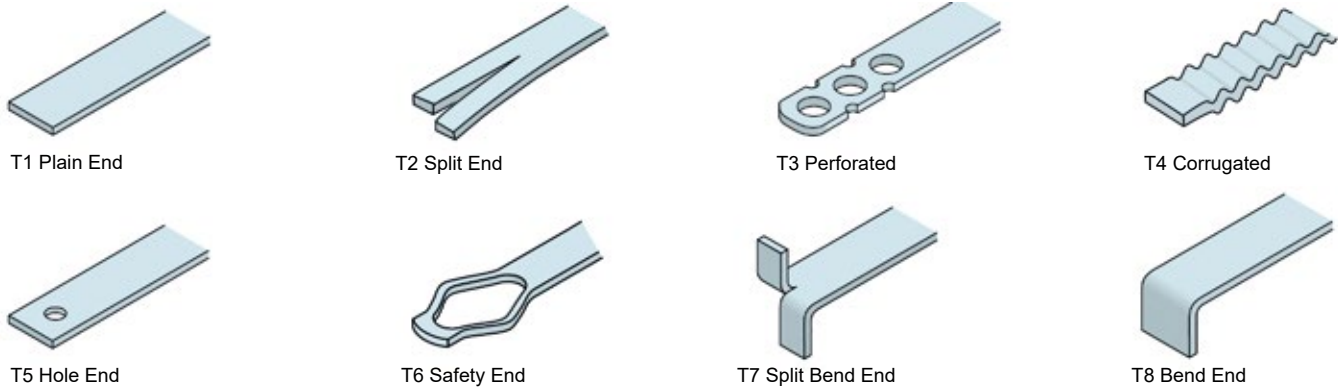

Head Options

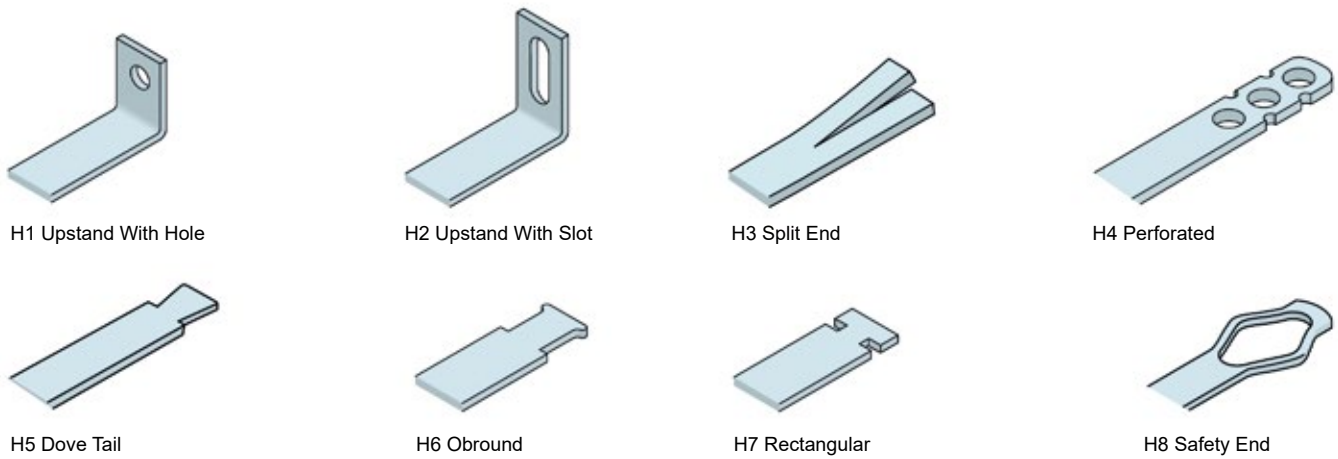

Body Options

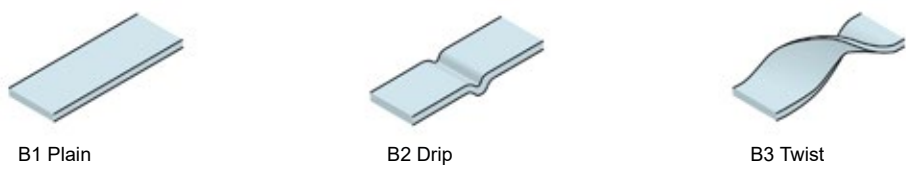

Sliding Anchor Stems

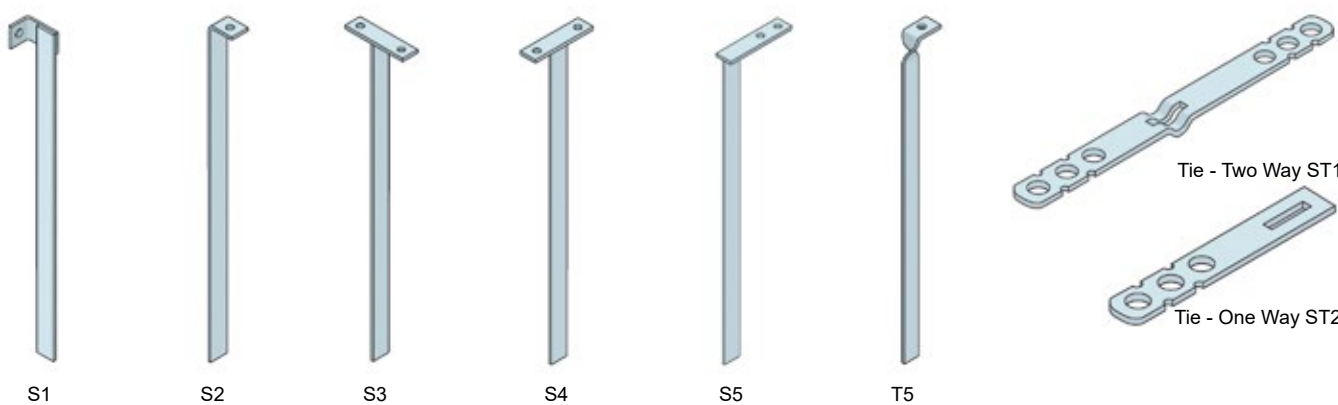



## Over Head Restraints

Over head restraints are designed for restraining the free standing wall with the overhead structure. The sliding tie is fixed to the overhead structure to arrest side movements and the vertical movement due to shrinkage and thermal movement is absorbed by sliding tie.



Reference	Length (mm)	Width (mm)	Upstand (mm)	Thickness (mm)	Material	Packing Pcs/box
VMT	200/250/300	30/35/40	30/50/75	1.5/2.0/2.5	Galvanized/Stainless Steel	250
CWT	200/250/300	30/35/40	30/50/75	1.5/2.0/2.5	Galvanized/Stainless Steel	250
VHT	200/250/300	30/35/40	30/50/75	1.5/2.0/2.5	Galvanized/Stainless Steel	250

- Table Shows sleeve details only.
- Ties are supplied as per the sleeve design.
- Custom designs and other sizes are available on request

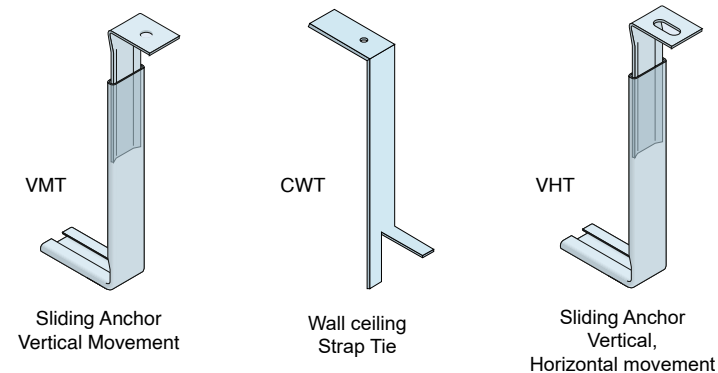

## Anchor Plates

Anchor plates are used to attach structural members to concrete structure. Angles can be used to frame openings in concrete walls. Various sizes and thickness are available as a simple and economical system.

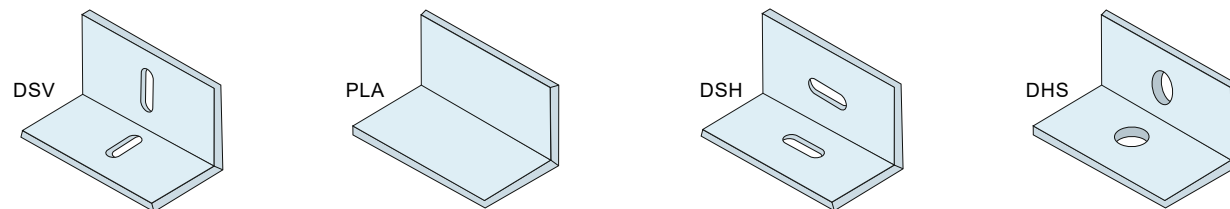

- Custom design and sizes are available on request

## Partition Top Anchors

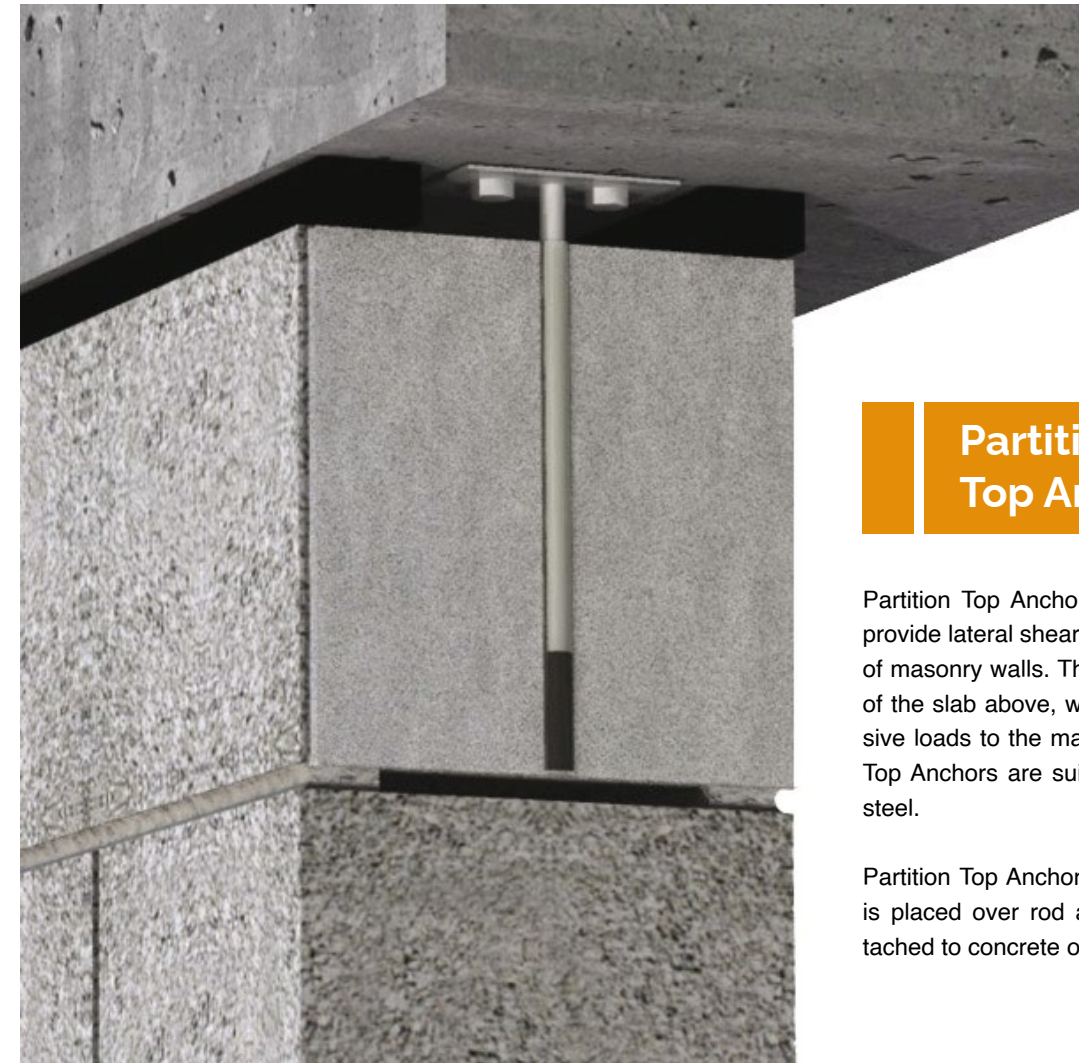

Partition Top Anchors have been developed to provide lateral shear resistance at the upper limit of masonry walls. They permit vertical deflection of the slab above, without transferring compressive loads to the masonry wall below. Partition Top Anchors are suitable for construction using steel.

Partition Top Anchors Tube with expansion filler is placed over rod anchor, which has been attached to concrete or steel



Reference	Plate Thk	Rod Dia	Rod Length	Qty/Box
PTA2.5	2.5 mm	10mm	150mm	50
PTA 4	4 mm	10mm	150mm	50





# PLASTER ACCESSORIES

- Angle Beads
- Micro Angle Beads
- Plaster Stop Beads
- Micro Plaster Stop Beads
- Architrave Beads with Return Flange
- Architrave Beads with Out Return Flange
- Architrave Beads Double Sided Mesh
- Movement Beads
- Control Joint Beads
- Render Stop Beads
- Corner Mesh
- Expanded Metal Lath
- Sheet Lath
- Strip Mesh
- Coil Lath
- Fiber Glass Plaster Reinforcing Fabric



## Angle Bead

Angle beads provide a true straight arris protect and reinforces corners from chipping and cracking. The expanded metal wings ensure that the bead is firmly embedded in the plaster. Galvanized Angle beads are recommended for internal plastering and Stainless Steel Angle beads are recommended for external rendering.

Galvanized Steel			
Reference	Size	Length(M)	Qty/Box
GAB 45	45 mm	2.7/3.0	50
GAB 50	50 mm	2.7/3.0	50
GAB 55	55 mm	2.7/3.0	50
GAB 65	65 mm	2.7/3.0	25
GAB 70	70 mm	2.7/3.0	25
GAB 75	75 mm	2.7/3.0	25

Stainless Steel			
Reference	Size	Length(M)	Qty/Box
SAB 45	45 mm	2.7/3.0	50
SAB 50	50 mm	2.7/3.0	50
SAB 55	55 mm	2.7/3.0	50
SAB 65	65 mm	2.7/3.0	25
SAB 70	70 mm	2.7/3.0	25
SAB 75	75 mm	2.7/3.0	25

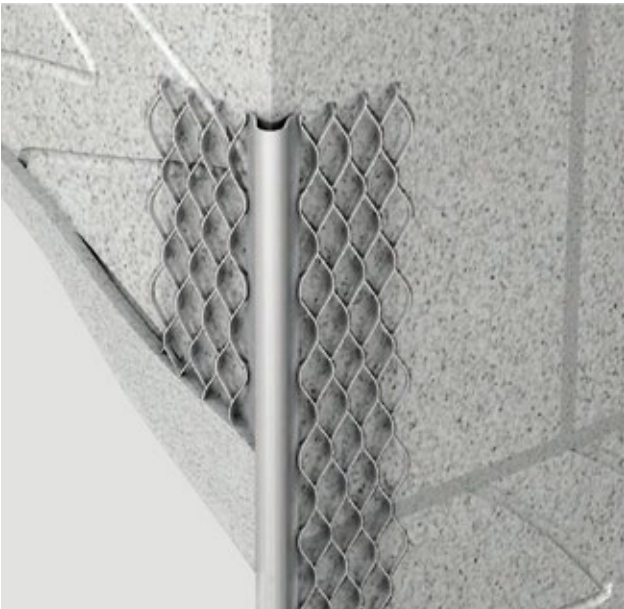

### Fixing

These are fixed by nailing or using plaster dabs. Please ensure to use only stainless steel nails with stainless steel Angle beads.

- Other Sizes, powder coated or special coated material also available on request

## Micro Angle Bead

Thin coat Angle beads are specially designed for use with all types of thin single coat plaster work, to provide protection and reinforcement at vulnerable points.

Galvanized Steel			
Reference	Size	Length(M)	Qty/Box
GMA25	25mm	3.0	50

Stainless Steel			
Reference	Size	Length(M)	Qty/Box
SMA25	25mm	3.0	50

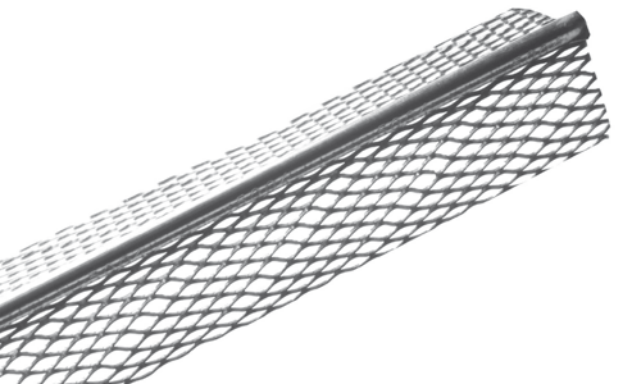

### Fixing

Fix either by nailing or plaster dabs. Ensure to use stainless steel nails with stainless steel Micro Angle beads.

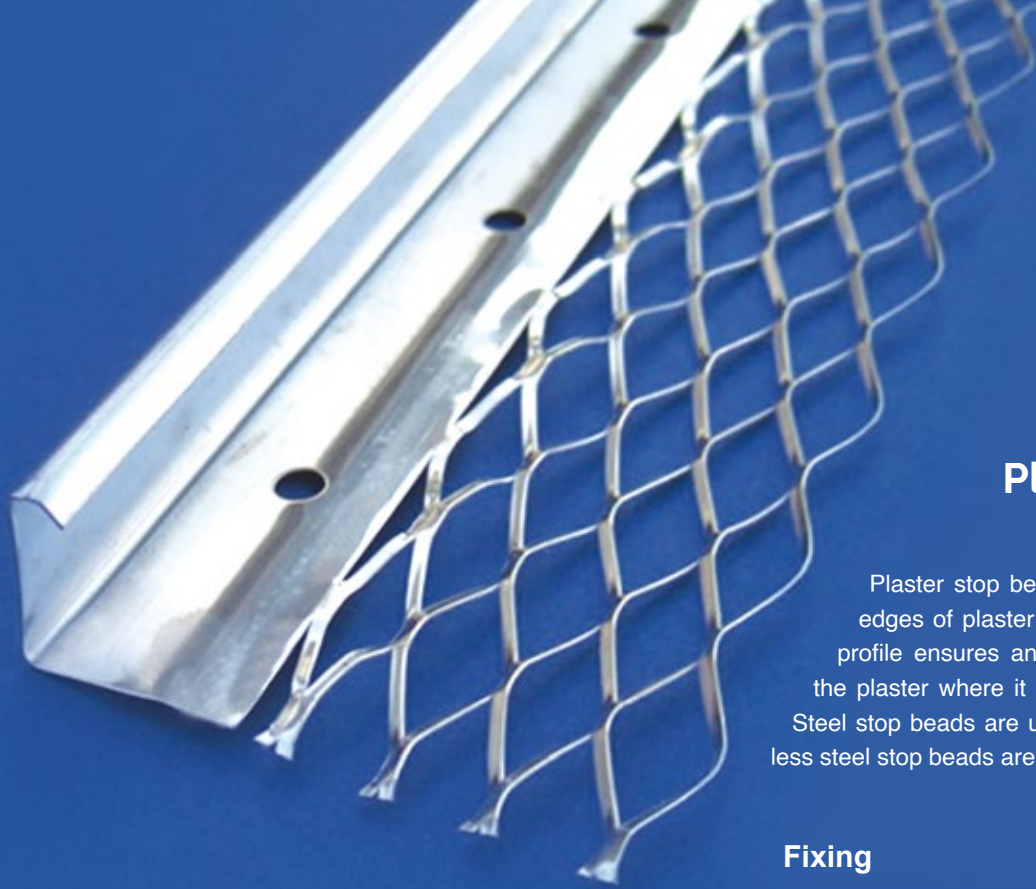

## Plaster Stop Bead

Plaster stop bead gives better finishing to the edges of plaster work. The straight edge of the profile ensures an accurate finish line protecting the plaster where it is most vulnerable. Galvanized Steel stop beads are used for internal use and Stainless steel stop beads are recommended for external use.

### Fixing

Plaster stop beads are fixed either by nailing or by using plaster dabs. Always ensure to use stainless steel nails for fixing Stainless Steel Stop beads.

Galvanized Steel			
Reference	Size	Length(M)	Qty/Box
GSB 10	10 mm	2.7/3.0	50
GSB 13	13 mm	2.7/3.0	50
GSB 16	16 mm	2.7/3.0	50
GSB 19	19 mm	2.7/3.0	50

Stainless Steel			
Reference	Size	Length(M)	Qty/Box
SSB 10	10 mm	2.7/3.0	50
SSB 13	13 mm	2.7/3.0	50
SSB 16	16 mm	2.7/3.0	50
SSB 19	19 mm	2.7/3.0	50

## Micro Plaster Stop Bead

Designed for thin / single coat plaster and are used for the finishing and reinforcing of plaster edges.

Galvanized Steel			
Reference	Size	Length(M)	Qty/Box
GMPS 6	6 mm	3.0	50

Galvanized Steel			
Reference	Size	Length(M)	Qty/Box
SMPS 6	6 mm	3.0	50

### Fixing

Fix either by nailing or using plaster dabs.







## Architrave Bead with Return Flange

Architrave beads are designed to provide a shadow line decorative effect for aesthetic look and creates a clean division between varying wall finishes eg.at wall and ceiling abutments or door and window reveals. Galvanized steel beads are used for internal applications and Stainless Steel beads are used for external applications.

### Fixing

Fixing either by nailing or plaster dabs. Ensure to use stainless steel nails with Stainless steel beads.

#### Galvanized Steel

Reference	Width	Length(M)	Depth	Qty/Box
GAR 10 W	10 mm	3.0	10/13	50
GAR 13 W	13 mm	3.0	10/13	50
GAR 15 W	15 mm	3.0	10/13	25
GAR 20 W	20 mm	3.0	10/13	25
GAR 25 W	25 mm	3.0	10/13	25

#### Stainless Steel

Reference	Width	Length(M)	Depth	Qty/Box
SAR 10 W	10 mm	3.0	10/13	50
SAR 13 W	13 mm	3.0	10/13	50
SAR 15 W	15 mm	3.0	10/13	25
SAR 20 W	20 mm	3.0	10/13	25
SAR 25 W	25 mm	3.0	10/13	25

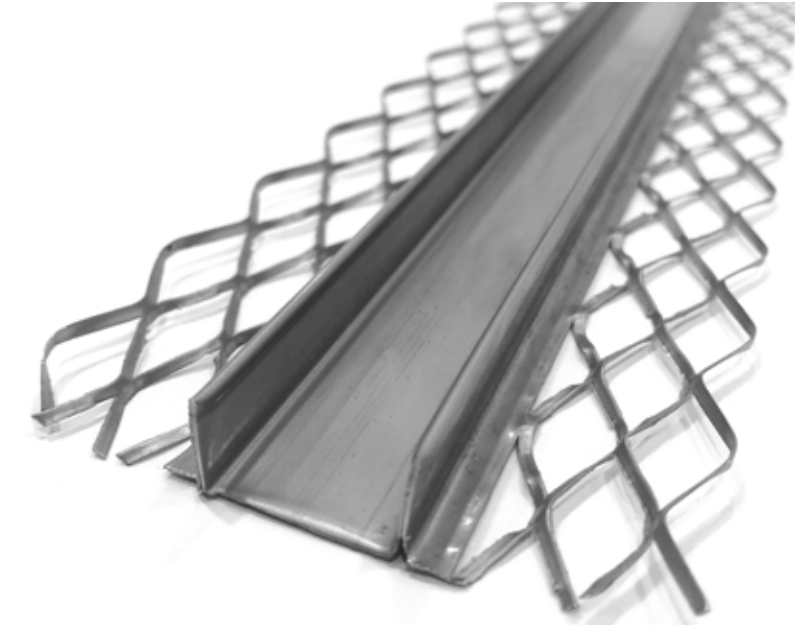

## Architrave Bead Double Side Mesh

Mainly used for decorative purposes to give a channel gap on wall finishes (i.e., wall and ceiling or door and window reveals).

#### Galvanized Steel

Reference	Width	Length(M)	Depth	Qty/Box
GAR 10 DW	10 mm	3.0	10/13	20
GAR 15 DW	15 mm	3.0	10/13	20
GAR 20 DW	20 mm	3.0	10/13	20
GAR 25 DW	25 mm	3.0	10/13	20

#### Stainless Steel

Reference	Width	Length(M)	Depth	Qty/Box
SAR 10 DW	10 mm	3.0	10/13	20
SAR 15 DW	15 mm	3.0	10/13	20
SAR 20 DW	20 mm	3.0	10/13	20
SAR 25 DW	25 mm	3.0	10/13	20

### Fixing

Fix either by nailing or using plaster dabs.

## Architrave Bead with out Return Flange

Used for decorative purposes to give a shadow between different walls finishes. (i. e. wall and ceiling or door and window reveals)

#### Galvanized Steel

Reference	Width	Length(M)	Depth	Qty/Box
GAR 10	20 mm	3.0	10	50
GAR 13	20 mm	3.0	13	50

#### Stainless Steel

Reference	Width	Length(M)	Depth	Qty/Box
SAR 10	20 mm	3.0	10/13	50
SAR 13	20 mm	3.0	10/13	50

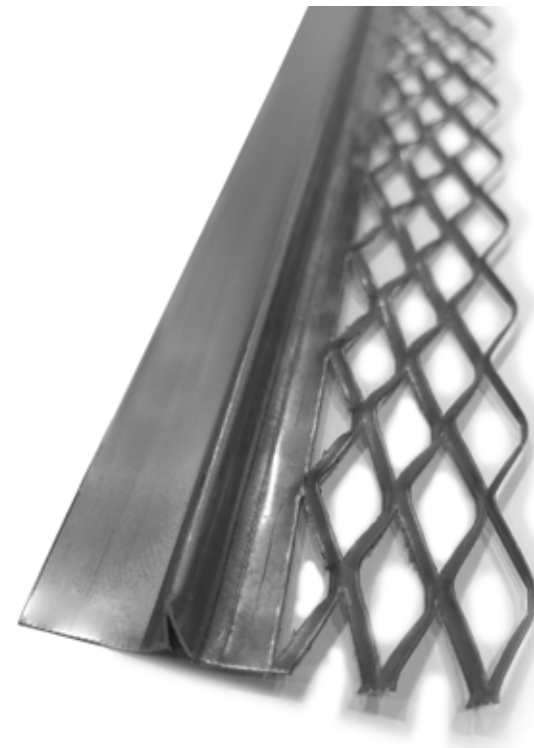

### Fixing

Fixing either by nailing or plaster dabs. Ensure to use stainless steel nails with Stainless steel beads.



## Movement Bead

Movement beads allow for movement between adjoining surfaces finishes resulting from differential expansion or settlement. When placed vertically it allows a 6mm movement and prevents cracking. Galvanized Movement beads are recommended for internal applications and Stainless Steel Movement beads are recommended for external applications.

#### Galvanized Steel

Reference	Size	Length(M)	Qty/Box
GMB 10	10 mm	3.0	50
GMB 13	13 mm	3.0	50
GMB 16	16 mm	3.0	50
GMB 19	19 mm	3.0	50

#### Stainless Steel

Reference	Size	Length(M)	Qty/Box
SMB 10	10 mm	3.0	50
SMB 13	13 mm	3.0	50
SMB 16	16 mm	3.0	50
SMB 19	19 mm	3.0	50

### Fixing

Fixed either by nailing or by using plaster dabs. Always ensure to use stainless steel nails for fixing Stainless Steel beads.





## Control Joint Beads

Designed to deal with normal initial stucco shrinkage during the hydrating and curing stage of the portland cement stucco (generally exterior or gypsum plaster interior) coats and minor thermal expansion and contraction.

### Galvanized Steel

Reference	Size	Length(M)	Qty/Box
GCJ 13	13 mm	3.0	50
GCJ 21	21 mm	3.0	50

### Stainless Steel

Reference	Size	Length(M)	Qty/Box
SCJ 13	13 mm	3.0	50
SCJ 21	21 mm	3.0	50

### Fixing

Fix either by nailing or using plaster dabs.

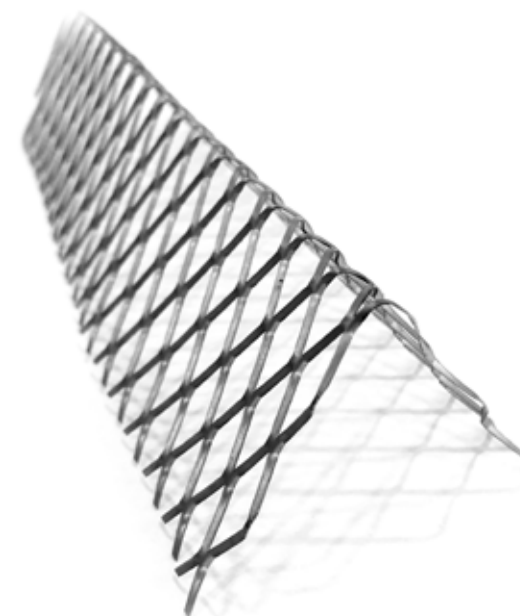

## Corner Mesh

Corner mesh is used for reinforcing internal and external corners of dissimilar material base

### Galvanized Steel

Reference	Size	Length(M)	Wt/M <sup>2</sup>	Qty/Box
GCM 50M	50 mm	2.5	1.11Kg	50
GCM 75M	75 mm	2.5	1.11Kg	50
GCM 50H	50 mm	2.5	1.61Kg	50
GCM 75H	75 mm	2.5	1.61Kg	50

### Stainless Steel

Reference	Size	Length(M)	Wt/M <sup>2</sup>	Qty/Box
SCM 50M	50 mm	2.5	1.11Kg	50
SCM 75M	75 mm	2.5	1.11Kg	50
SCM 50H	50 mm	2.5	1.61Kg	50
SCM 75H	75 mm	2.5	1.61Kg	50

### Fixing

Fixed either by nailing or by using plaster dabs. Always ensure to use stainless steel nails for fixing Stainless Steel beads.

## Render Stop beads

Major purpose is to obtain a lower edge to external finishes and to protect stonework from water.

### Galvanized Steel

Reference	Size	Length(M)	Qty/Box
GRS 13	13 mm	3.0	50
GRS 16	16 mm	3.0	50
GRS 19	19 mm	3.0	50

### Stainless Steel

Reference	Size	Length(M)	Qty/Box
SRS 13	13 mm	3.0	50
SRS 16	16 mm	3.0	50
SRS 19	19 mm	3.0	50

### Fixing

Fix either by nailing or using plaster dabs.



## Expanded Metal Lath

Expanded Metal Lath is extensively used as a background to plaster in order to reinforce against cracks. It is especially useful at Joints of dissimilar materials and at crack prone areas. Suitable for internal and external applications, Core Metal Lathing is easily formed and it can be used as a carrier for fire protection finishes to structural steelwork. Depending on the applications Metal Lath comprises Sheet Lath, Strip Mesh and Coil Lath.

Core Metal Lathing is simple to use and easy to work with is designed to provide durable, effective solutions to all kinds of plastering or rendering works. Galvanized Steel Lath is used for internal use and Stainless Steel Lath is recommended for areas with high humidity, moisture and for external works.

### Fixing

Lath is fixed by nailing or with plaster dabs. Always use stainless steel nails with stainless steel lath.

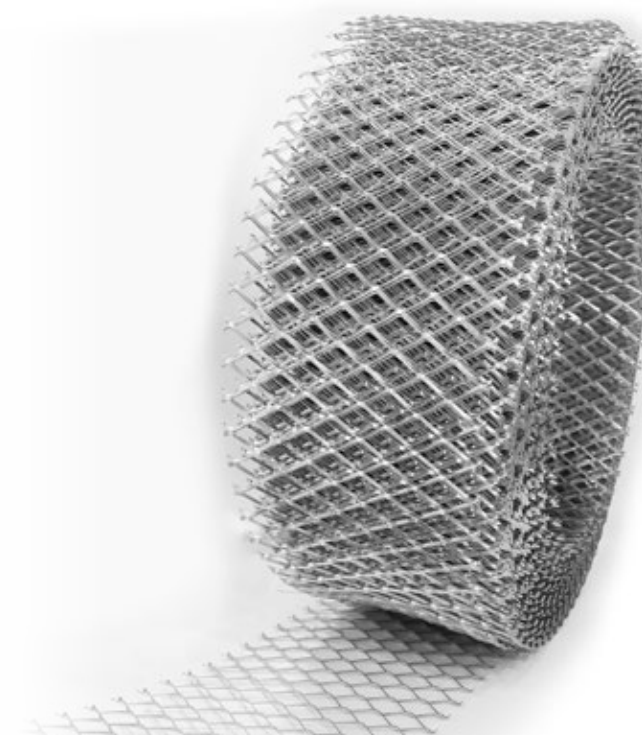



Sheet Lath

Fixing

These are fixed either by nailing or using small plaster dabs. Ensure to use stainless steel nails with stainless steel Sheet Lath.



Galvanized Steel			
Reference	Size	Weight/M <sup>2</sup>	Packing
GSL-SL	2500 x 600mm	0.70 Kg	10/Bundle
GSL-L	2500 x 600mm	0.91 Kg	10/Bundle
GSL-M	2500 x 600mm	1.11 Kg	10/Bundle
GSL-H	2500 x 600mm	1.61 Kg	10/Bundle
GSL-E	2500 x 600mm	1.85 Kg	10/Bundle
GSL-S	2500 x 600mm	2.00 Kg	10/Bundle

Stainless Steel			
Reference	Size	Weight/M <sup>2</sup>	Packing
SSL-SL	2500 x 600mm	0.70 Kg	10/Bundle
SSL-L	2500 x 600mm	0.91 Kg	10/Bundle
SSL-M	2500 x 600mm	1.11 Kg	10/Bundle
SSL-H	2500 x 600mm	1.61 Kg	10/Bundle
SSL-E	2500 x 600mm	1.85 Kg	10/Bundle
SSL-S	2500 x 600mm	2.00 Kg	10/Bundle

Strip Mesh

Galvanized Steel			
Reference	Size	Weight/M <sup>2</sup>	Packing
GSM-101	2500 x 150mm	0.91 Kg	10/Bundle
GSM-102	2500 x 150mm	1.11 Kg	10/Bundle
GSM-103	2500 x 150mm	1.61 Kg	10/Bundle
GSM-104	2500 x 150mm	1.85 Kg	10/Bundle
GSM-105	2500 x 150mm	2.00 Kg	10/Bundle
GSM-106	2500 x 200mm	0.91 Kg	10/Bundle
GSM-107	2500 x 200mm	1.11 Kg	10/Bundle
GSM-108	2500 x 200mm	1.61 Kg	10/Bundle
GSM-109	2500 x 200mm	1.85 Kg	10/Bundle
GSM-110	2500 x 200mm	2.00 Kg	10/Bundle

Stainless Steel			
Reference	Size	Weight/M <sup>2</sup>	Packing
SSM-101	2500 x 150mm	0.91 Kg	10/Bundle
SSM-102	2500 x 150mm	1.11 Kg	10/Bundle
SSM-103	2500 x 150mm	1.61 Kg	10/Bundle
SSM-104	2500 x 150mm	1.85 Kg	10/Bundle
SSM-105	2500 x 150mm	2.00 Kg	10/Bundle
SSM-106	2500 x 200mm	0.91 Kg	10/Bundle
SSM-107	2500 x 200mm	1.11 Kg	10/Bundle
SSM-108	2500 x 200mm	1.61 Kg	10/Bundle
SSM-109	2500 x 200mm	1.85 Kg	10/Bundle
SSM-110	2500 x 200mm	2.00 Kg	10/Bundle

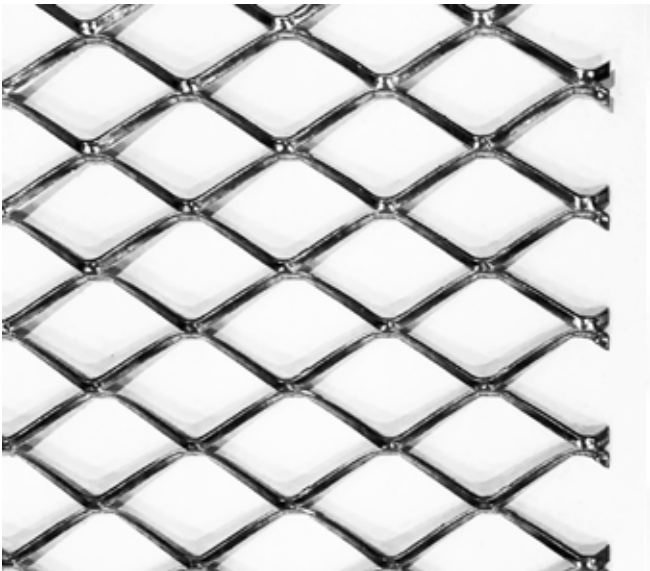

Used to provide reinforcement to plaster between dissimilar areas and at crack-prone areas adjacent to openings. Galvanized strip mesh is used for internal application and Stainless steel strip mesh is used for external application.

Fixing

These are fixed either by nailing or using small plaster dabs. Ensure to use stainless steel nails with stainless steel Sheet Lath.

- Other sizes also available on request

Coil Lath

Fixing

These are fixed either by nailing or using small plaster dabs. Ensure to use stainless steel nails with stainless steel coil Lath.

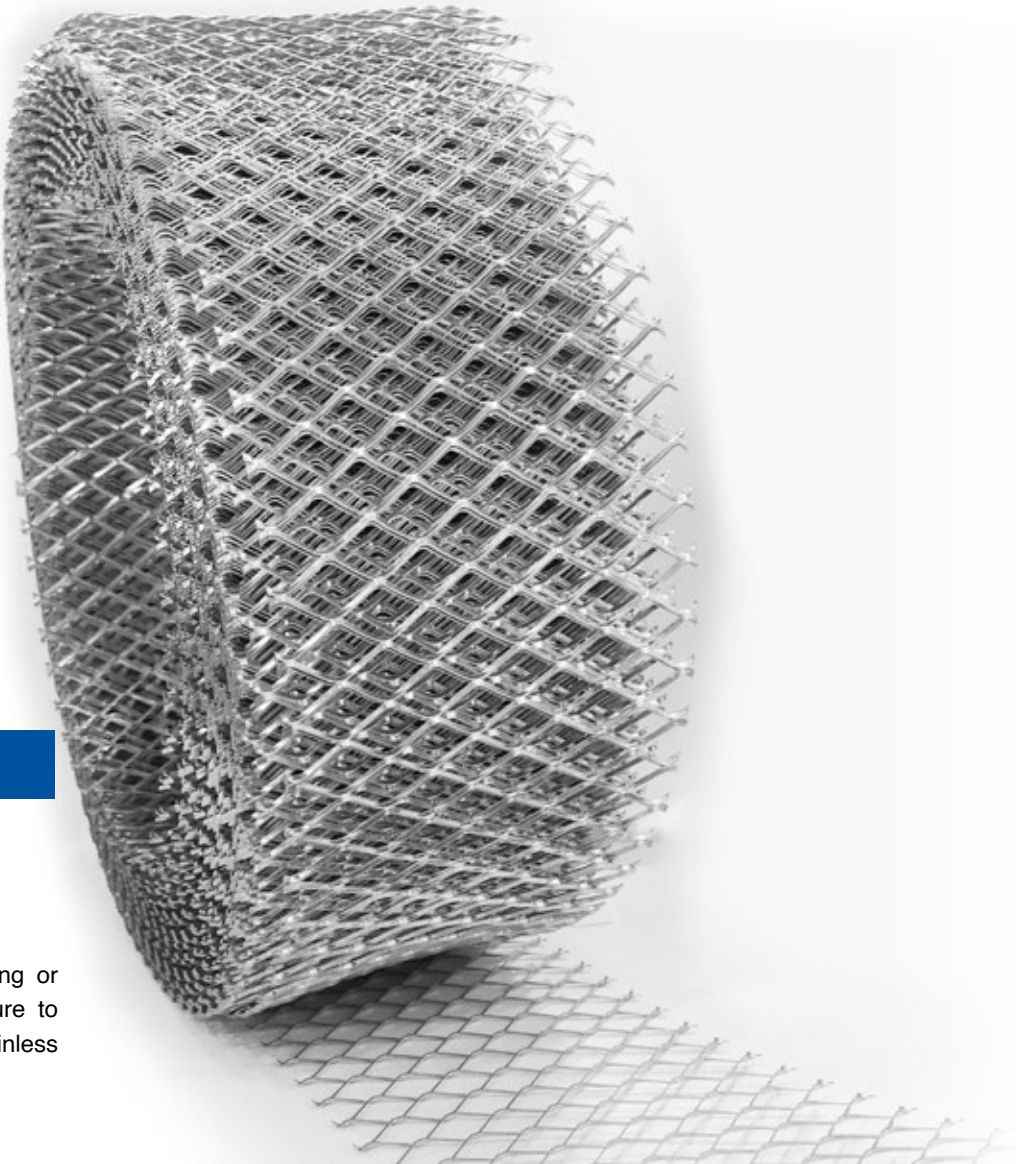

Galvanized Steel			
Reference	Size	Weight/M <sup>2</sup>	Length(M)
GCL 100SL	100 mm	0.70 Kg	100/50
GCL 100L	100 mm	0.91 Kg	100/50
GCL 100M	100 mm	1.11 Kg	100/50
GCL 100H	100 mm	1.61 Kg	100/50
GCL 100E	100 mm	1.85 Kg	100/50
GCL 150SL	150 mm	0.70 Kg	100/50
GCL 150L	150 mm	0.91 Kg	100/50
GCL 150M	150 mm	1.11 Kg	100/50
GCL 150H	150 mm	1.61 Kg	100/50
GCL 150E	150 mm	1.85 Kg	100/50
GCL 200SL	200 mm	0.70 Kg	100/50
GCL 200L	200 mm	0.91 Kg	100/50
GCL 200M	200 mm	1.11 Kg	100/50
GCL 200H	200 mm	1.61 Kg	100/50
GCL 200E	200 mm	1.85 Kg	100/50
GCL 300SL	300 mm	0.70 Kg	100/50
GCL 300L	300 mm	0.91 Kg	100/50
GCL 300M	300 mm	1.11 Kg	100/50
GCL 300H	300 mm	1.61 Kg	100/50
GCL 300E	300 mm	1.85 Kg	100/50

- Other sizes also available on request

Stainless Steel			
Reference	Size	Weight/M <sup>2</sup>	Length(M)
SCL 100SL	100 mm	0.70 Kg	100/50
SCL 100L	100 mm	0.91 Kg	100/50
SCL 100M	100 mm	1.11 Kg	100/50
SCL 100H	100 mm	1.61 Kg	100/50
SCL 100E	100 mm	1.85 Kg	100/50
SCL 150SL	150 mm	0.70 Kg	100/50
SCL 150L	150 mm	0.91 Kg	100/50
SCL 150M	150 mm	1.11 Kg	100/50
SCL 150H	150 mm	1.61 Kg	100/50
SCL 150E	150 mm	1.85 Kg	100/50
SCL 200SL	200 mm	0.70 Kg	100/50
SCL 200L	200 mm	0.91 Kg	100/50
SCL 200M	200 mm	1.11 Kg	100/50
SCL 200H	200 mm	1.61 Kg	100/50
SCL 200E	200 mm	1.85 Kg	100/50
SCL 300SL	300 mm	0.70 Kg	100/50
SCL 300L	300 mm	0.91 Kg	100/50
SCL 300M	300 mm	1.11 Kg	100/50
SCL 300H	300 mm	1.61 Kg	100/50
SCL 300E	300 mm	1.85 Kg	100/50



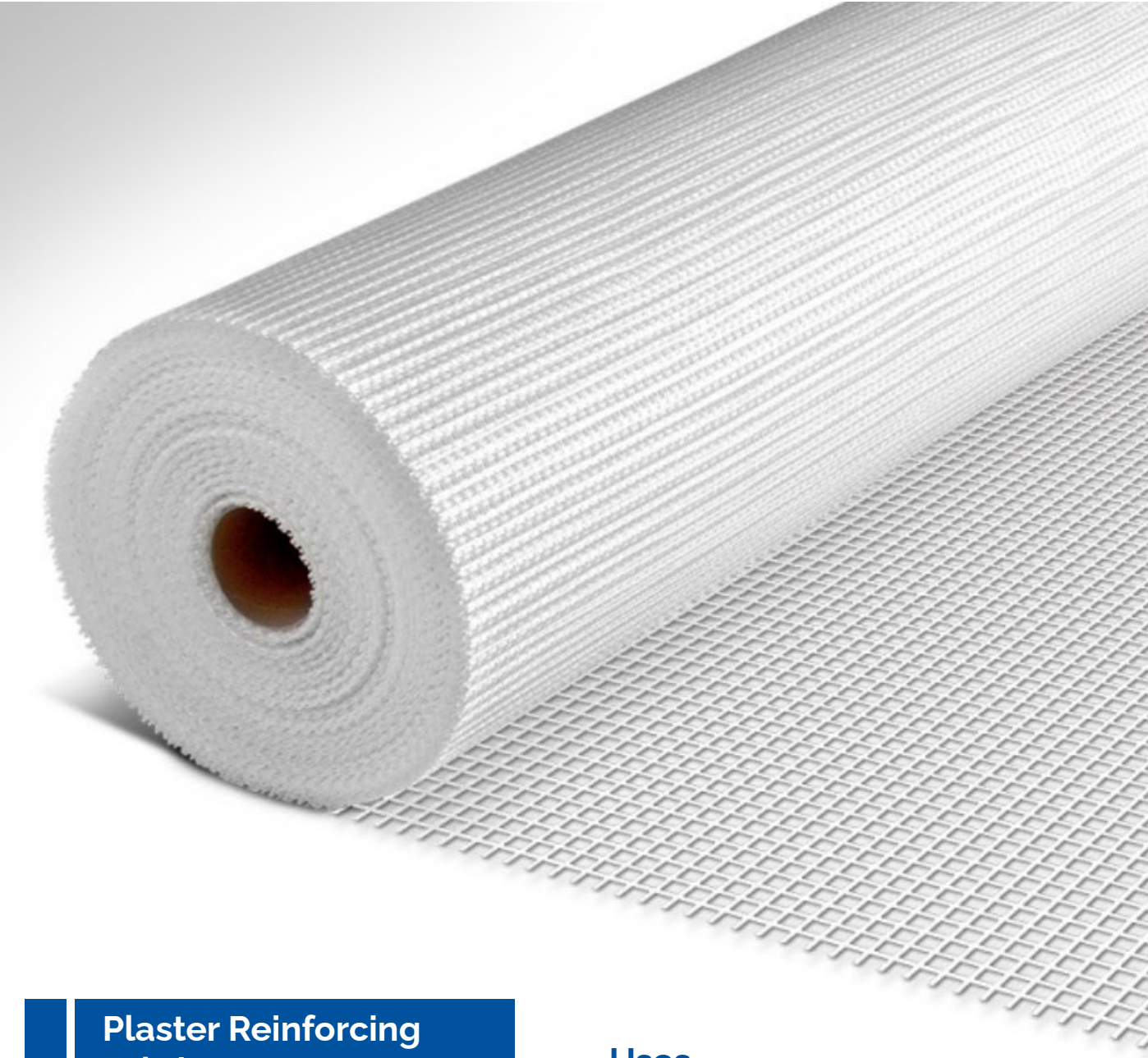

# Plaster Reinforcing Fabric

Fibreglass Reinforcement solutions that are less costly and more effective than steel. High performance, full strength, alkali-resistant products will not rot, rust or corrode. They are also lightweight and easy to install and use. These innovative, superior alternatives to steel mesh are easy to work-with, will not rust or rot and provide increased strength in every cementitious application.

Fibreglass Reinforcement Mesh is used for reinforcement of inside concrete floors and walls elimination of cracks during repair of thin concrete layers and other non-structural concrete applications in buildings.

## Uses

- To reinforce all types of plaster,applied externally or internally.
- For load-bearing construction and general renovation work.
- For repair work and general renovation application.
- Preventing cracks in plastering.
- As reinforcing base for gypsum or wooden surface

### Installation:

Wet the surface thoroughly and apply a thin coat of plaster. Press the fabric gently with a trowel in the fresh plaster. Apply the final layer of plaster.

## Advantage

- High Alkali Resistant
- Non Corrosive
- Low Elongation
- East to Install - No Hammering or Nailing
- Excellent adhesion with all types of plaster.

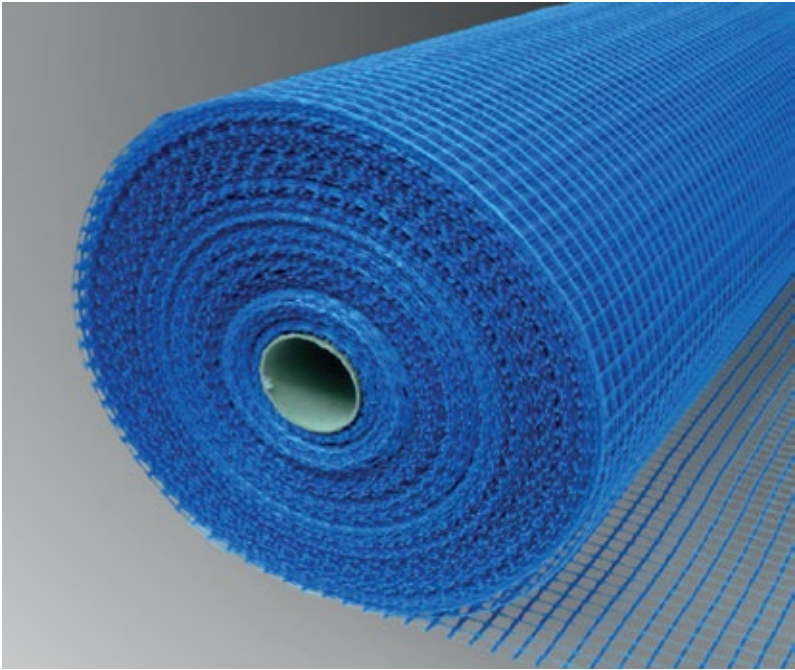

## Technical Specification

Mesh Size	: 5x5 mm ± 0.5 mm
Weave Construction	: Warp : 5*2 per inch Weft : 4.5 per inch
Warp Yarn	: 134 Tex glass yarn
Weft Yarn	: 400 Tex glass roving
Weave Type	: Leno
Thickness	: 0.38 ± 0.02 mm
Coating	: Alkali Resistant (Tensile Strength retention more than 50%)
Finish	: Medium Hard
Total gsm	: 160 ± 5% gsm
Width	: 1000 mm
Feather Edge	: Slit Edge
Length	: 50 M Roll
Tensile Strength	: Warp 2400 N/5 CM with Elongation- 4.0% Warp 2000 N/5 CM with Elongation- 4.0%

Mesh Size	: 8x8 mm ± 0.5 mm
Weave Construction	: Warp : 5*2 per inch Weft : 4.5 per inch
Warp Yarn	: 134 Tex glass yarn
Weft Yarn	: 400 Tex glass roving
Weave Type	: Leno
Thickness	: 0.38 ± 0.02 mm
Coating	: Alkali Resistant (Tensile Strength retention more than 50%)
Finish	: Medium Hard
Total gsm	: 80 ± 5% gsm
Width	: 1000 mm
Feather Edge	: Slit Edge
Length	: 50 M Roll
Tensile Strength	: Warp 1100 N/5 CM with Elongation- 3.8% Warp 900 N/5 CM with Elongation- 3.8%





A close-up, high-angle photograph of a metal lath. The lath features a series of parallel, wavy, ribbed strips that are spaced evenly apart. The metal has a brushed, industrial finish. The perspective is from above, looking down at the lath, which creates a strong sense of depth and texture. The lighting is bright, highlighting the metallic sheen and the shadows between the ribs.

**HI RIB LATH**  
**RIB LATH**



## Hi Rib Lath

Hi Rib Lath is mainly used as a permanent formwork for concrete shuttering. Used for columns, retaining walls and joints, it creates a strong base and mechanical key for successive concrete pours, with its angled tabs of mesh becoming embedded with the concrete.

Hi Rib Lath is light weight, easily bent, and cut in to required shapes. Its use eliminates the complex carpentry works and can be installed quickly. Hi Rib Lath will retain the concrete that is poured, with the resulting surface requiring no special bonding preparation for the next pour. Also every pour can be visually monitored and reduces the risk of honey combing.

Reference	Size	Rib Depth	Weight/M <sup>2</sup>
GHR L	2200X445mm	21mm	3.39kg
GHR M	2200X445mm	21mm	4.86kg
GHR H	2200X445MM	21mm	6.34kg

### Cutting

- Hi Rib is cut using the metal shears or the circular saw. Avoid deforming the rib.
- Cut the spine of the expanded metal rib work
- Bend the material
- Cut off the High-Rib panels

## Hi Rib , Setting up a stop end for construction joints

### Processing

- Hi Rib (1) is nailed to a corner or shaped bracing (2). Ribs should not be damaged or distorted during fixing. The closed expanded metal rib work point towards the first concreted section as the expanded metal rib work here is exposed to the most pressure. The expanded metal rib work is arranged cross-wise to the bracings.
- Hi Rib requires the same concrete coverage a reinforced concrete. In order to maintain the specified concrete coverage, the upper and underside of the component are fitted with wooden strips (3) as spacers and nailed to the bracings (2).
- The bracings (2) themselves are nailed to the formwork and held in place by wooden bars (4) supported by the existing armouring.

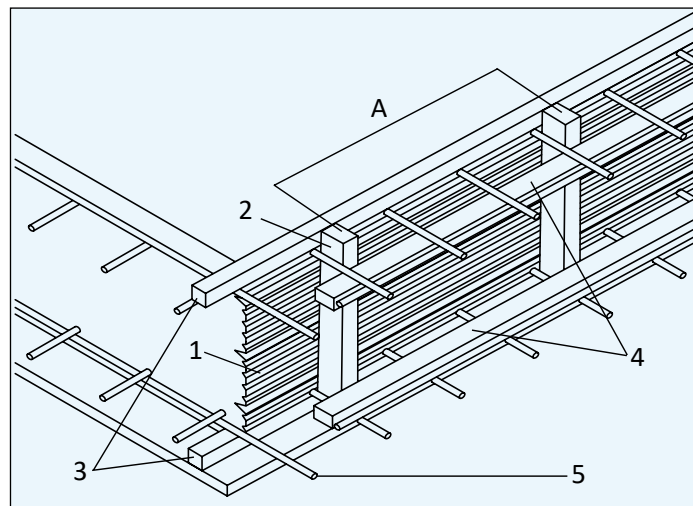

## Permanent Concrete Formwork

Hi Rib is designed in such a way that it can be placed closed to the edge rib of the neighbouring Hi Rib panel. This ensures solid joints across the entire length and the stiffness of the panel joints in the preparation stage is strengthened.

The intermediate ribs of the Hi Rib panels create the internal stiffness along the length of the panel allowing supports to be bridged. As a result of the reduced load, less support system are required.

The fixture of Hi Rib panels can be carried out either before or after the application of armouring.

## HI RIB LATH ESSENTIALS

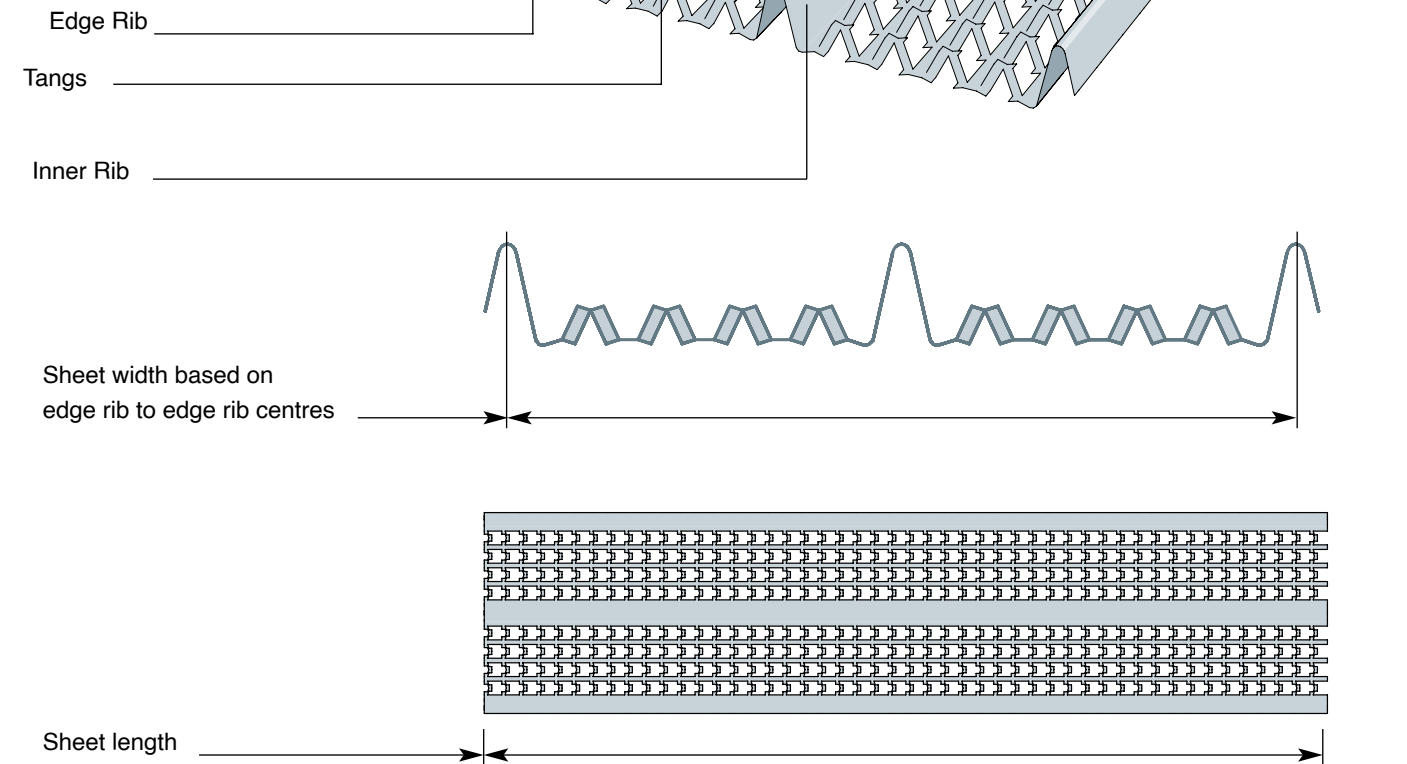

## Rib Lath

Rib Lath is a specially designed expanded metal lath for the construction of suspended ceilings and stud wall partitions. This lath has an integral stiffening ribs rolled-formed during manufacturing. The mesh areas of the lath are expanded. The Rib Lath is easy to handle and can be cut with hand shears and bent to the required angles.

### Galvanized Steel

Reference	Width	Length	Depth	Weight	Qty/Box
GRL 1.4	600mm	2.5 mtr	10mm	1.48Kg/m2	25
GRL 1.8	600mm	2.5 mtr	10mm	1.84Kg/m2	25
GRL 2.2	600mm	2.5 mtr	10mm	2.22Kg/m2	25

### Stainless Steel

Reference	Width	Length	Depth	Weight	Qty/Box
SRL 1.4	600mm	2.5 mtr	10mm	1.48Kg/m2	25
SRL 1.8	600mm	2.5 mtr	10mm	1.84Kg/m2	25
SRL 2.2	600mm	2.5 mtr	10mm	2.22Kg/m2	25





Coremetal offers high performance supporting system for gypsum board partition and ceiling, providing effective fire protection and sound insulation.

They are cost effective, suitable for all types of commercial, recreational and residential developments

## CEILING FURRING & DRY WALL PARTITION SYSTEM





## Ceiling Furring System

Furring Channel system comprises of a furring channel attached to the primary channel by a wire clip. The system is further supported by a perimeter angle and the entire system is suspended by various hanging methods. It is a high performance support system for Gypsum Board, providing sound insulation and fire protection that can be used for new ceiling structures or to upgrade existing ceilings.

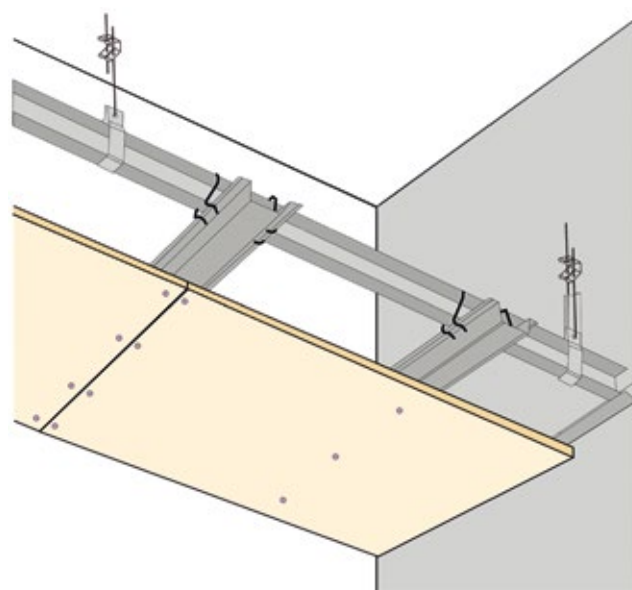

Furring system is suitable for most commercial, recreational, retail and residential buildings and is fully compatible with our Stud and Track Partitioning system.

## Furring Channel

Reference	Dimensions (mm)			Thickness (mm)	Length (mm)	Material
	A	B	C			
CFC 35	35	22	68	0.4 to 1.2	3000	Galvanized

- Other sizes also available on request

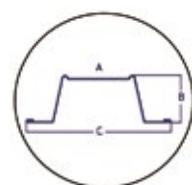

## Main Channel

Reference	Dimensions (mm)			Thickness (mm)	Length (mm)	Material
	A	B	C			
CMC 38	12	38	12	0.4 to 1.2	3000	Galvanized

- Other sizes also available on request

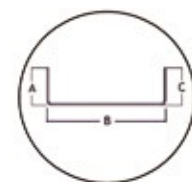

## Wall Angle

Reference	Dimensions (mm)		Thickness (mm)	Length (mm)	Material
	A	B			
CWA 25	25	25	0.4 to 1.2	3000	Galvanized

- Other sizes also available on request

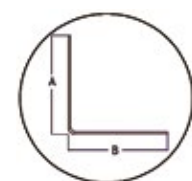

## Dry Wall Partition System

Stud and Track Partitioning System is a versatile lightweight, non-load bearing system and can be easily assembled at site, saving on time. These are very cost effective and suitable for all types of commercial, recreational, industrial and residential developments. This section allows inclusion of services during construction.

Stud and Track partitioning is fully compatible with our ceiling furring systems.

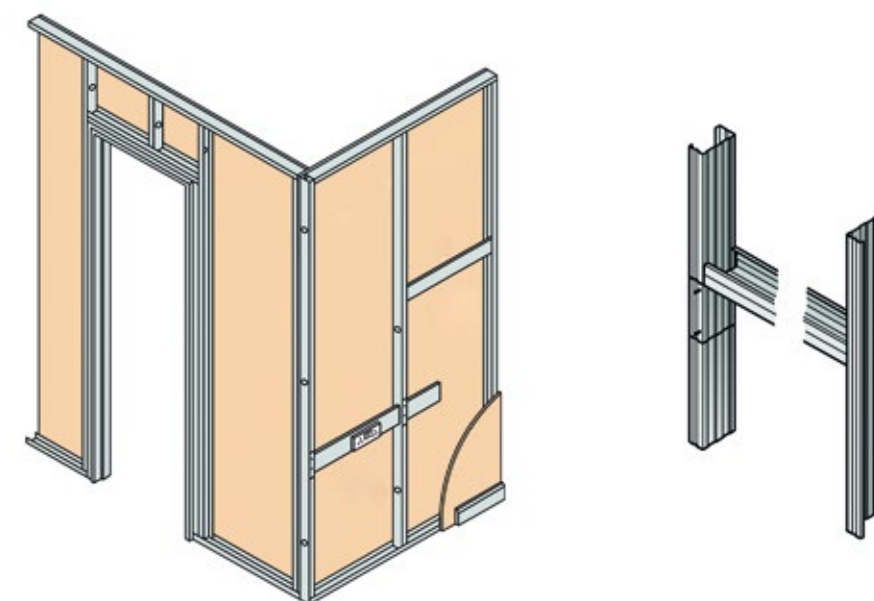

## Stud

Reference	Dimensions (mm)			Thickness (mm)	Length (mm)	Material
	A	B	C			
ST 50	50	36	34	0.4 to 1.2	3000	Galvanized
ST 70	70	36	34	0.4 to 1.2	3000	Galvanized
ST 98	98	36	34	0.4 to 1.2	3000	Galvanized

- Other sizes also available on request

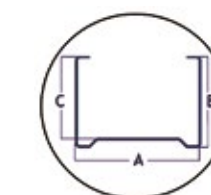

## Track

Reference	Dimensions (mm)			Thickness (mm)	Length (mm)	Material
	A	B	C			
TR 52	52	25	23	0.4 to 1.2	3000	Galvanized
TR 72	72	25	23	0.4 to 1.2	3000	Galvanized
TR 100	100	25	23	0.4 to 1.2	3000	Galvanized

- Other sizes also available on request

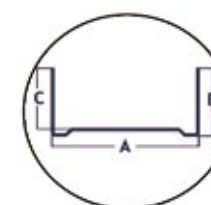



PRODUCT TECHNICAL SPECIFICATIONS

Expanded Metal Lath & Block Work Mesh	
Manufacturing standard	BS EN 13658-1&2:2005(Formerly BS1369:Part 1:1987) ASTM C 847
Galvanized Steel	BS EN 10346:2009(Formerly BS EN 10142:1991,BS EN 10327) Hot Dipped Galvanised Coating Type Z180-275/450 ASTM A 653/A 653 M
Stainless Steel	BS EN 10088-2:2005(Formerly BS1449:Part 2:1983 Grade 304 2 B Finish ASTM A 240/A 240M Grade 304 2B Finish Grade 316/316L

Reinforcement Mesh Ladder / Truss Type & Expanded Type	
Manufactured to	BS EN 845-3:2003 ASTM A 951/A 951 M
Stainless Steel Wire	BS EN 10088-3:2005(Formerly BS 1554:1990) ASTM A 1022 A /1022 M
Pre Galvanized Steel Wire	BS EN 10244-2:2001(Formerly BS 443) ASTM A 641/A 641M
Hot Dipped Galvanizing to	BS EN ISO 1461:1999(Formerly BS 729) ASTM A 123/A123M/A153/A153M
Cold Drawn Steel for concrete/	BS 4482:2005 ASTM A 1064/ A1064M (Formerly ASTM A496 & ASTM A185) ASTM A82 / A82 M
Masonry Reinforcement	ASTM A 496/A 496 M/A 82/A 82 M

Metal Beads	
Manufacturing standard	BS EN 13658-1 & 2:2005(formerly BS 6452:Part 1:1984) ASTM C 841, ASTM C 1063
Galvanized Steel	BS EN 10346:2009(Formerly BS EN 10142:1991) Hot Dipped Galvanised Coating Type Z180-275/450 ASTM A 653/A 653 M
Stainless Steel	BSEN 10088-2:2005(Formerly BS 1449:Part 2:1983 Grade 304 2B Finish ASTM A240/A240M Grade 304 2B Finish Grade 316/316L ASTM A666, In Grade 304
Installation	BS 5492:1990, BS 5262:1991

Hi Rib Lath	
Galvanized Steel	BS EN 10346 ( Formerly BS EN 10327) Hot Dipped Galvanised Coating Type Z180-275/450
Stainless Steel	BS EN 10088-1

PRODUCT TECHNICAL SPECIFICATIONS

Wire	
Manufactured to	BS EN 845-1:2003 (Formerly BS 1243)
Mild Steel Wire	BS 1052:1980,BS 4482:2005
Galvanized Wire	BS EN 10244-2:2001(Formerly BS 443:1982) ASTM A 641/A 641 M
Hot Dipped Galvanizing to	BS EN ISO 1461:1999(Formerly BS 729) ASTM A 123/A123 M
Stainless Steel Wire	BS EN 10088-3:2005(Formerly BS 1554:1990) ASTM A 580/ A 580 M Grade 304

Lintels	
Manufactured to	BS EN 845-2:2013+A1:2016 (Formerly BS EN 845-2:2003) BS 5977:PART 2 : 1983
Galvanized Steel	BS EN 10346:2009(Formerly BS EN 10142:1991) Hot Dipped Galvanised Coating Type Z180-275/450
Testing	BS 476

Wall Ties	
Sheet	
Manufactured to	BS EN 845-1:2003(Formerly BS 1243)
Pre-Galvanized Steel	BS EN 10346:2009(Formerly BS EN 10142:1991) ASTM A 653/A 653 M
Mild Steel	BS EN 10149-3:1996; BS EN 10268:2006 ASTM A 1008/A1008M
Hot dipped Galvanizing to	BS EN ISO 1461:1999(Formerly BS 729) ASTM A 123/A123 M/A 153/A153 M
Stainless Steel	BS EN 10088-2:2005(Formerly BS 1449 PART 2:1983 Grade 304 2B Finish) ASTM A 240/A 240 M Grade 304 Grade 316/316L

Dry Wall Partitioning & Dry line ceiling System	
Galvanized Steel	BS EN 10346:2009(Formerly BSEN 10142:1991) Hot Dipped Galvanised Coating Type Z180-275/450 ASTM A 653/A653M
Manufactured to	BS EN 13658-1 & 2:2005 (Formerly BS 6452:Part 1: 1984) BS EN 10162:2003,BS 5234-1:1992,BS 7364:1990 BS EN 14195:2005,ASTM C 1047
Hot Dipped Galvanization (After Fabrication)	BS EN 1461:1999(Formerly BS 729) ASTM A123/A123 M/Galvanized Steel



## GROUP COMPANIES

- Core Metal LLC - Steel Stockist**  
Structural Steel, GI, Aluminium & SS
- Coremetal Technical Services LLC**  
Design and Engineering
- Embosal Tube Mills LLC**  
Tubes and Pipe Mill
- Core Metallic Ind. LLC - Expanded Metal**  
Expanded Metal & Profile Manufacturing
- Core Metallic Ind. LLC - Steel Fabrication**  
Structural & Architectural Steel Fabrication
- Core Metallic Ind. LLC - Metal Processing**  
Water jet, Plasma, Punching & Perforation
- Core Metallic Ind. LLC - Machine Shop**  
CNC Machining & Tooling, Mandrel Manufacturing
- CorePac Industries LLC**  
Manufacturer of Disposable Packaging & Solutions
- CorePac FZE**  
Disposable Packing and Hospitality Items
- ASMECO Fire Protection LLC**  
Fire proof Painting (Intumescent & Cementitious Coating)
- ASMECO Coating Industries LLC**  
Abrasive Blast Cleaning, Specialized Protective Coating

# COREMETAL®

### Core Metallic Ind. L.L.C - Expanded Metal Division

Tel: +971 6 5013 111, Fax: +971 6 5540 619  
P.O.Box: 95801, Sharjah, U.A.E

Email: [em@coreindustry.net](mailto:em@coreindustry.net) | [www.coreindustry.net](http://www.coreindustry.net)